

* Some of the contents of this manual may differ from your phone, depending on the software installed or your service provider.



PORTABLE CELLULAR TELEPHONE SCH-X619

User's Manual



World Wide Web
<http://www.samsungmobile.com>

Printed in Korea
Code No. : GH68-05412A
English. 08/2004. Rev.1.0



Table of contents

| | |
|--|----|
| Important safety precautions | 7 |
| Unpacking | 9 |
| Your phone | |
| Phone's parts | 10 |
| Display | 13 |
| Backlight | 15 |
| Service LED | 16 |
| Camera | 16 |
| Getting started | |
| Using a UIM card | 17 |
| Using a battery | 18 |
| Switching the phone on or off | 24 |
| Using the PIN code | 25 |
| Using the soft keys | 26 |
| Your phone's modes | 27 |
| Call functions | |
| Making a call | 30 |
| Ending a call | 31 |
| Emergency dialling | 31 |
| Using the recent call logs | 32 |
| Making a call from phonebook | 32 |
| Prepend dialling | 33 |
| Speed-dialling | 34 |
| Pause dialling | 36 |
| Adjusting the volume during a call | 38 |
| Answering a call | 39 |
| Silencing a call ringer | 40 |
| Rejecting a call | 40 |
| Viewing missed calls | 41 |
| Options during a call | 41 |

Call functions (continued)

| | |
|-------------------------|----|
| Call forwarding | 42 |
| Call waiting | 43 |
| Three-way calling | 44 |

Entering text

| | |
|------------------------------------|----|
| Changing the text input mode | 46 |
| Using T9 word mode | 47 |
| Using ABC mode | 49 |
| Using 123 mode | 52 |
| Using symbol mode | 52 |

Using the menus

| | |
|--|----|
| Accessing a menu function by scrolling | 53 |
| Using shortcuts | 54 |
| List of menu functions | 55 |

Calls

| | |
|-------------------------------|----|
| Missed (Menu 1-1) | 60 |
| Incoming (Menu 1-2) | 61 |
| Outgoing (Menu 1-3) | 62 |
| Erase logs (Menu 1-4) | 62 |
| Air time (Menu 1-5) | 63 |
| Call forward (Menu 1-6) | 64 |
| Call waiting (Menu 1-7) | 65 |

Phonebook

| | |
|-----------------------------|----|
| Find (Menu 2-1) | 66 |
| Add (Menu 2-2) | 70 |
| Group set (Menu 2-3) | 76 |
| My phone # (Menu 2-4) | 76 |

Messages

| | |
|------------------------------|----|
| New message (Menu 3-1) | 78 |
| Inbox (Menu 3-2) | 79 |
| Outbox (Menu 3-3) | 81 |
| Erase msgs (Menu 3-4) | 82 |
| Msg setup (Menu 3-5) | 82 |

Scheduler

| | |
|-------------------------------|----|
| View month (Menu 4-1) | 85 |
| Jump to date (Menu 4-2) | 88 |
| Alarm set (Menu 4-3) | 88 |
| Calculator (Menu 4-4) | 89 |
| Today (Menu 4-5) | 90 |
| To do list (Menu 4-6) | 91 |
| Memo pad (Menu 4-7) | 92 |
| Countdown (Menu 4-8) | 93 |
| World time (Menu 4-9) | 94 |

Entertainment

| | |
|--------------------------------|-----|
| Music box (Menu 5-1) | 95 |
| Image box (Menu 5-2) | 96 |
| Games (Menu 5-3) | 98 |
| MP3 player (Menu 5-4) | 100 |
| Memory status (Menu 5-5) | 103 |

Settings

| | |
|-------------------------------|-----|
| Sounds (Menu 6-1) | 104 |
| Display (Menu 6-2) | 108 |
| Auto retry (Menu 6-3) | 112 |
| Answer mode (Menu 6-4) | 112 |
| Roam option (Menu 6-5) | 113 |
| Security (Menu 6-6) | 114 |
| Entry method (Menu 6-7) | 120 |

| | |
|--|-----|
| Camera | |
| Taking a photo | 121 |
| Take photo (Menu 7-1) | 125 |
| Record video (Menu 7-2) | 125 |
| Photo album (Menu 7-3) | 128 |
| Video album (Menu 7-4) | 129 |
| Settings (Menu 7-5) | 131 |
| Memory status (Menu 7-6) | 131 |
| Wireless web | |
| About the Web browser | 132 |
| Health and safety information | |
| SAR certification information | 137 |
| Precautions when using batteries | 138 |
| Road safety | 140 |
| Operating environment | 140 |
| Electronic devices | 141 |
| Potentially explosive environments | 143 |
| Emergency calls | 144 |
| Other important safety information | 145 |
| Care and maintenance | 146 |
| Glossary | 148 |
| Quick reference card | 151 |

Important safety precautions

Read these guidelines before using your wireless phone. Failure to comply with them may be dangerous or illegal.

Road safety at all times

Do not use a hand-held phone while driving; park the vehicle first.

Switching off when refuelling

Do not use the phone at a refuelling point (service station) or near fuels or chemicals.

Switching off in an aircraft

Wireless phones can cause interference. Using them in an aircraft is both illegal and dangerous.

Switching off near all medical equipment

Switch off your phone near the medical equipment. Hospitals or health care facilities may be using equipment that could be sensitive to external RF energy. Follow any regulations or rules in force.

Interference

All wireless phones may be subject to interference, which could affect their performance.

Special regulations

Meet any special regulations in force in any area and always switch off your phone whenever it is forbidden to use it, or when it may cause interference or danger (in a hospital for example).

Water resistance

Your phone is not water-resistance. Keep it dry.

Sensible use

Use only in the normal position (held to the ear).
Avoid unnecessary contact with the antenna when the phone is switched on.

Emergency call

Key in the emergency number for your present location, then press the  key. Give all the necessary information as accurately as possible. Do not cut off the call until given permission to do so.

Keeping small children away from your phone

Keep the phone and all its parts including accessories out of the reach of small children.

Accessories and batteries

Use only Samsung-approved accessories and batteries. Use of any unauthorised accessories could damage your phone and may be dangerous.

Qualified service

Only qualified service personnel may install or repair your phone.

For more detailed safety information, see "Health and safety information" on page 137.

CAUTION

RISK OF EXPLOSION IF A BATTERY IS
REPLACED BY AN INCORRECT TYPE.
DISPOSE USED BATTERIES ACCORDING
TO THE INSTRUCTIONS.

Unpacking

Your package contains the following items. The illustrations below may look different from your phone and accessories.



Phone



Travel adapter



Batteries



Battery charger



Straight headset



Finger strap



Data cable



User's manual

Phone's parts

The following illustrations show the main elements of your phone:

With the phone open



With the phone closed



Key(s) Functions



(Soft keys)

Performs the functions indicated by the text above them, on the bottom line of the display.



(Navigation keys)

In Menu mode, scrolls through the menus. In Standby mode, enters the following menus respectively:

- Up: **MP3 player**. This key accesses the MP3 file list when pressed and held.
- Down: **Games**
- Left: **Messages**
- Right: **View month**



Enters the **Wireless Web** menu. Also, quickly launches the web browser when held down.



Makes or answers a call. In Standby mode, retrieves the last numbers you dialed or received.

Key(s) **Functions** *(continued)*

Ends a call. Also switches the phone on and off when pressed and held.
In Menu mode, cancels your input and returns to Standby mode.



Deletes characters from the display.
In Menu mode, returns to the previous menu level.



Enters numbers, letters and some special characters.



In Standby mode, allows you to change the voice calls when pressed and held.
In the text entry mode, changes the case of letters.



In Standby mode, quickly enters or exits silent mode when pressed and held.
In the text entry mode, inserts a space.



(on the left side of the phone)
During a call, adjust the earpiece volume.
In Standby mode, adjust the keypad tone volume.
During playback of an MP3 music file, adjust the sound.



(on the right side of the phone)
In Standby mode, enters the **Camera** menu
In Standby mode, turns on the camera when pressed and held. To take a photo with the folder closed, press and hold this key.
During playback of an MP3 music file, pauses or resumes the playback.

Display

The display has three areas:

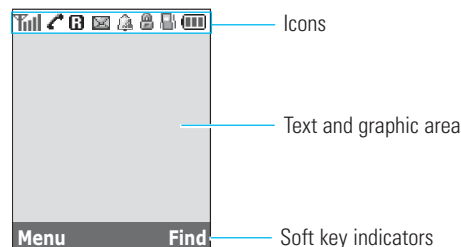

Icons



Signal strength: Shows the received signal strength. The greater the number of bars, the better the signal.



Service: Appears when a call is in progress.



No service: Appears when you are outside a service area. When it displays, you cannot make or receive calls. Wait a little while for a better signal or move into an open area to regain service.



New SMS message: Indicates that there is an SMS new message waiting to be checked.

Icons *(continued)*



Alarm mode: Appears when you set an alarm to ring at a specified time.



Lock mode: Appears when your phone is locked.



Restriction: Appears when you restrict the use of your phone.



Roaming: Appears when you are out of your home area and have logged onto a different network; for example, when travelling in other countries.



Vibration mode: Appears when the ringer volume for calls is set to **Vibrate** or when your phone is in **Silent** mode.



Ringer off: Appears when the ring volume for calls is set to **Silent**.



Battery status: Shows the level of your battery. The more bars you see, the more power you have left.

External display

Your phone has an external display on the folder. When the folder is closed, it indicates that you have an incoming call or message. It also alerts you when you have set an alarm at the specified time by displaying the corresponding icon.

When you close the folder, the external display turns on and then off after the length of time specified at the factory.

To turn the display on, press and hold one of the Volume keys on the left side of the phone.

Backlight

The backlight illuminates the display and keypad. When you press any key or open the folder, the backlight illuminates. It turns off if no key is pressed within a given period of time, depending on the **Backlight** option set in the **Display** menu.

To specify the length of time the phone waits before the backlight turns off, set the **Backlight** menu (**Menu 6-2-2**). See page 109 for further details.

Note: After the backlight turns off, the display also turns off to conserve battery power. In Standby mode it goes off after a given period of time depending on the setting in the **Backlight** menu and in Talk mode it goes off 10 seconds after the backlight turns off. Press any key to turn the display on.

Service LED

The service light on the folder flashes to indicate an incoming call, message or alarm and blinks for a few seconds when you turn the phone on or off. It also flashes while the battery is charging with the travel adapter.

To activate or deactivate the service light, use the **Service LED** menu (**Menu 6-2-7**). See page 111.

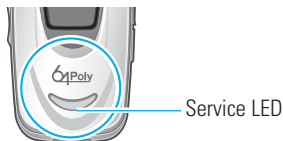

Camera

The camera module on the folder allows you to take a photo or record a video while on the move.

For further details about the Camera feature, see page 121.

Getting started

Using a UIM card

The UIM (User Identification Module) card contains a chip with all the information required to operate your phone. Note the following:

- Keep all miniature UIM cards out of the reach of small children.
- The UIM card and its contacts can easily be damaged by scratching or bending, so be careful when handling, inserting or removing the card.

Installing the UIM card

1. If necessary, remove the battery. Refer to page 19.
2. Slide the UIM card into the slot, as shown, ensuring that the metal contacts of the card face into the phone.

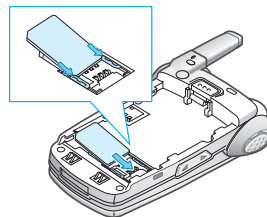

Removing the UIM card

Slide the UIM card out of the slot.

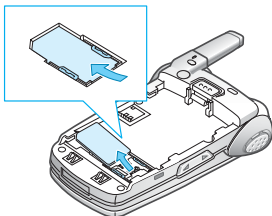

Using a battery

Your phone is powered by a rechargeable Li-ion battery. Use only approved batteries and chargers. Ask your local Samsung dealer for further details.

Note: You must fully charge the battery before using your phone for the first time. A discharged battery is fully recharged in approximately 200 minutes for a standard battery.

Installing the battery

1. Place the battery back on the phone so that its tabs match the grooves on the phone.

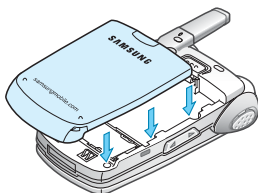

2. Slide the battery towards the top of the phone until it snaps into place.

Make sure that the battery is properly installed before switching the phone on.

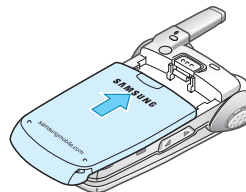

Removing the battery

1. If necessary, switch the phone off by pressing and holding the  key until the closing image displays.
2. To remove the battery:
 - ① Press the catch above the battery and hold it in that position.
 - ② Slide the battery and lift it away, as shown.

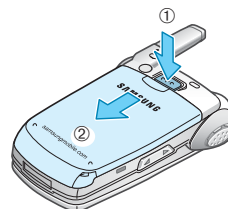

Charging the battery

A travel adapter and a battery charger are provided for charging your batteries.

Using the travel adapter

The travel adapter allows you to use the phone while the battery is charging, but this causes the battery to charge more slowly.

1. With the battery in position on the phone, plug the connector of the travel adapter into the jack at the bottom of the phone.

Make sure that the arrow on the connector is facing toward the front of the phone.

2. Plug the adapter into a standard AC wall outlet.

The Battery Strength icon on the display repeatedly blinks to indicate that the phone is now charging the battery.

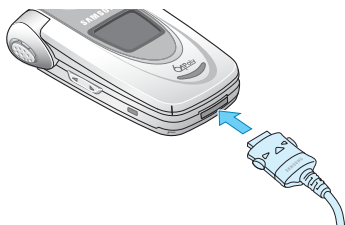

3. When charging is finished and the service light turns to green, unplug the adapter from the power outlet and disconnect it from the phone by pressing the buttons on both sides of the connector (see ①) and pulling the connector out (see ②).

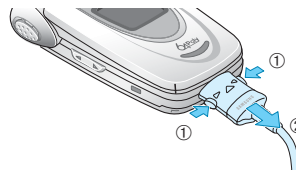

Note: You must unplug the adapter before removing the battery from the phone during charging; otherwise, the phone could be damaged.

Using the battery charger

Using the battery charger, you can charge the battery alone.

1. Insert the battery only into the slot of the battery charger ensuring that the terminals on the battery are in contact with those on the charger. Press the battery down until it clicks into place.

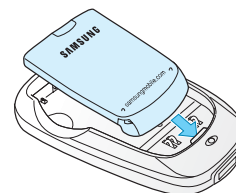

2. Plug the connector of the travel adapter into the jack at the bottom of the charger.

The small light, LED, on the charger turns on.

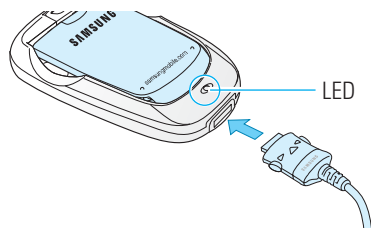

3. Plug the adapter into a standard AC wall outlet.

You can see the LED on the charger indicating the charging progress by the following colours:

- Red: the battery is being charged.
- Green: the battery is completely charged.
- Yellow: the battery is not correctly plugged in or is operating at a too high or too low temperature.

4. When charging is finished, unplug the adapter from both the power outlet and from the charger.

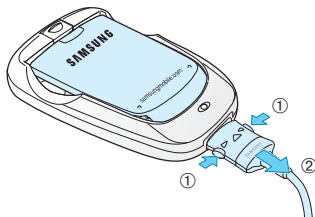

5. Remove the battery from the battery charger.

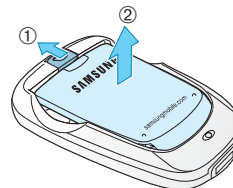

Low battery indicator

When the battery is weak and only a few minutes of talk time remain, the battery sensor lets you know by blinking the empty Battery Strength icon (). You will hear a warning tone and a message at regular intervals on the display.

When the battery becomes too weak for the phone to operate, it switches off automatically.

Note: Once the Low Battery Warning message has appeared, your phone won't play MP3 music files or turn on the camera.

Switching the phone on or off

1. Open the folder.
2. Press and hold the  key for more than one second to turn the phone on.
3. If the phone asks for a Personal Identification Number (PIN), enter the PIN code supplied with the UIM card. For further details about the code, see the next page.

The service light flashes and an alert sounds. When the system locates services, you can see the standby mode screens on both displays.

If the phone is out of the service area, the No service icon () appears on the display. In this case, you cannot place and receive calls. You can try again later when service is available.

Note: You can change the display language in the **Language** menu (**Menu 6-2-3**). See page 109.

4. When you wish to turn the phone off, press and hold the  key for more than two seconds.

WARNING!

Do not switch the phone on when mobile phone use is prohibited or when it may cause interference or danger.



Note: Do not touch the antenna on the phone unnecessarily when the phone is switched on. Contact with the antenna affects the call quality and may cause the phone to operate at a higher power level than otherwise needed.

Using the PIN code

The PIN code supplied with the UIM card helps you protect the UIM card against unauthorised use. When the phone asks you to enter the code, enter the appropriate code, displayed as asterisks for security. If you enter an incorrect PIN code three times in succession, your UIM card is blocked. To unblock the card, contact your service provider.

You can enable or disable the code using the **Card setup** menu (**Menu 6-6-8**). For further information, see page 118.

Using the soft keys

Your phone offers a set of functions that allows you to customise it. These functions are arranged in menus and sub-menus, accessed using the two soft keys marked  and . Each menu and sub-menu allows you to view and alter the settings of a particular function.

The roles of the soft keys vary according to the function you are currently using; the labels on the bottom line of the display just above each key indicates its current role.

Example:





Press the left soft key to access Menu mode.

Press the right soft key to find a number stored in Phonebook.

Your phone's modes

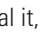
Standby mode

Standby is the most basic state of your phone. The phone goes into Standby mode soon after you turn it on, or whenever you briefly press the  key. When your phone is in Standby mode, you will see the current time and date. If you enter a phone number, you can press the  key to dial it, or press the **Save** soft key to save it in Phonebook.

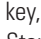
Press the  key at any time to return to Standby mode. Be careful; if you are on a call when you press the  key, your phone disconnects the call and returns to Standby mode.

Talk mode

You can place and answer calls only when your phone is turned on. During a call, the phone is in Talk mode. While you are in Talk mode, pressing the **Menu** soft key gives you a list of options. See page 41 for details.

Power save mode

Your phone comes with a Power save feature that automatically turns the display off when you don't use the phone. While this feature is active, the phone's battery charge is conserved.

The display switches off if no key is pressed within one minute after you press the last key or open the folder. You can press any key to activate the display.

Lock mode

When you lock your phone using the **Lock mode** menu (**Menu 6-6-1**), you cannot use the phone. In Lock mode, you can receive messages and calls, but you cannot place a call until you unlock the phone.

To unlock the phone, press one of the soft keys or the navigation keys, and then enter the lock code.

For further details about locking and unlocking the phone, see page 114.

Silent mode

Silent mode disables all sounds on the phone, except for the camera shutter sound. This feature is best used in situations where the phone might disturb others, such as in a meeting, at a library or in a theatre. Your phone can be set to Silent mode with a press of a key in Standby mode.

To enter Silent mode, press and hold the **#** key until "Entering silent mode" and the Vibration icon () appear.

To exit and reactive the previous sound settings, press and hold the **#** key until "Exit silent mode" appears. The Vibration icon no longer displays.

Note: Activating Silent mode will not turn off the camera shutter sound.

Call functions

Making a call

To make a call:

1. In Standby mode, enter the area code and phone number.

While entering a phone number, press the **Pause** soft key to insert a hard pause. For more information about pause dialling, see page 36.

2. Press the  key. The phone places the call to the entered phone number.

Note: When you have set the **Auto retry** menu (**Menu 6-3**) to **On**, the phone automatically retries to make the call if no one answers or if the line is busy. See page 112 for further details.

Correcting the number

| To clear | Press the |
|--------------------------|--|
| the last digit displayed | C key. |
| the whole display | C key and hold it for more than one second. |

Ending a call

When you want to end your call, press the  key.

The call time, or the length of the call, displays along with the phone number of the called person. If the number is stored in your Phonebook, the name displays. If there is no match, you can press the **Save** soft key and store the number in Phonebook. For further details about storing the number in Phonebook, see page 70.

Or, simply close the folder to end a call.







Emergency dialling

You can place calls to standard emergency numbers, such as 112, 113, 118, 199 and three specified numbers on the Emergency # list, even if your phone is locked or all outgoing calls are restricted. For further details about emergency numbers, see page 115.

Using the recent call logs

The phone stores up to 60 of the calls you dialled, received or missed chronologically. The last call is saved in the first position.

To recall any of these numbers:

1. If there are characters on the display, return to Standby mode by pressing the  key.
2. Press the  key. The list of recent calls displays.
 -  : Outgoing calls
 -  : Incoming calls
 -  : Missed calls
3. Press the Navigation key, or the Volume keys on the left side of the phone to scan through the list until you find the number you want.
4. Press the  key to dial the highlighted number.

Making a call from phonebook

You can store the phone numbers you call regularly in the UIM card and phone's memory, which is called "Phonebook." You then simply retrieve the number to dial. For further details about Phonebook, see page 66.

Prepend dialling

The Prepend option lets you add digits, such as area codes and network feature activation codes, to a phone number that is in your call logs before dialling it.

To prepend the phone numbers stored in the call logs:

1. Access a call log in the Recent Calls list referring to the previous page, or in the **Calls** menu (**Menu 1**) referring to page 60.
2. When the phone number you want to dial displays, press the **Menu** soft key to access the Menu pop-up list.
3. Press the **3** key to select the **Prepend** option.
4. Enter the area code or feature code.
5. Press the  key to dial the number.

Speed-dialling

Once you have stored phone numbers in Phonebook, you can dial them easily with a few presses of the keys.

From the UIM card memory

You can dial the phone numbers stored in the UIM card memory. The capacity of the card memory may vary depending on the card.

Enter the memory location of the number and press and hold the final digit to dial.

One-touch dial: Memory locations 001 through 009 are special one-touch locations. You can dial the phone numbers stored in the memory from 001 through 009 simply by pressing one key.

Press and hold the third digit of the memory location containing the number to be dialled.

For example: Location no. 009

Press the **9** key and hold.

The number (and name) stored displays, and then dials.

Two-touch dial: For memory locations of two digits.

Press the second digit briefly, then hold down the third digit of the memory cell.

For example: Location no. 023

Press the **2** key briefly and hold the **3** key.

The number (and name) stored displays, and then dials.

Three-touch dial: For memory locations of three digits.

Press the first and the second digit briefly, then hold down the third digit of the memory cell.

For example: Location no. 123

Press the **1** key and the **2** key briefly, and then hold the **3** key.

The number (and name) stored displays, and then dials.

From the phone's memory

Press the digits of the phone memory location containing the number to be dialled, then press and hold the **#** key.

For example: Location no. 029

Press the **2** key and the **9** key briefly, and then hold the **#** key.

The number (and name) stored displays, and then dials.

Pause dialling

When you call an automated system, like a banking service, you are often required to enter a password or account number. Instead of manually entering the numbers each time, you can store the numbers in your Phonebook, separated by pauses.

Storing pauses in a phonebook entry

To store a number in your Phonebook that contains pauses:

1. Enter the phone number you want to store, such as the bank's teleservice phone number.
2. Press the **Pause** soft key to insert a pause. A "P" displays, meaning that a hard pause will occur at that point in the dialling sequence.

The "P" stops the dialling and waits for the teleservice to prompt you for a number. The number following the "P" is your account number, PIN, etc.



3. Enter the digits that need to follow the pause, such as your account number.
4. Repeat steps 2 and 3 to add more pauses and numbers, if necessary.
5. Store the number in your Phonebook as you normally would by pressing the **Save** soft key and following from step 4 on page 70.

Pause dialling from a stored phonebook entry

1. Dial the number from Phonebook.
2. Wait for the appropriate prompt from the number you are calling.
3. When prompted, press the  key to send the DTMF (Dual Tone Multi Frequency) number that follows your pause.
"SEND DTMF" flashes on the display and the transmitted tone sounds.

Manual pause dialling

You can enter pauses manually during the dialling process.

1. Enter the phone number of the service you want to call, such as a bank's teleservice phone number.
2. Press the **Pause** soft key to insert a pause.
The screen displays a "P" indicating a pause.
3. Enter the number to be sent after the pause by pressing the digit keys.
4. Repeat steps 2 and 3 to add more pauses and numbers, if necessary.
5. Press the  key.
6. After connecting, wait for the prompt from teleservice. Press the  key again after the prompt to send the additional number(s).

Adjusting the volume during a call

During a call, if you want to adjust the voice volume, use the Volume keys on the left side of the phone.

Press the ▲ key to increase the volume level and the ▼ key to decrease the level. The graphics on the display shows all five levels; the more bars you see, the louder the volume.





In Standby mode, you can also adjust the volume for the key tones using these keys.

Answering a call

When somebody calls you, the phone alerts you by ringing and blinking the service light.

If the caller can be identified, the caller's phone number, or name if stored in your Phonebook, displays.

There are many ways to answer a call depending on your setting in the **Answer mode** menu (**Menu 6-4**);

| If you select | To answer the call, |
|----------------|---|
| By send key | press the  key. |
| By folder open | open the folder or press the  key. |
| By any key | open the folder or press any key except the  key, the soft keys and the Volume keys. |

To end the call, close the folder or press the  key.

Note: You can answer a call while using the Phonebook or menu features. The current operation stops.

Silencing a call ringer



You can silence the ringer when a call comes in by pressing one of the Volume keys on the left side of the phone or pressing the left soft key. The “Ringer silenced” message appears and the phone does not ring.

Rejecting a call

To reject an incoming call, press the right soft key or the  key. You can also reject the call by pressing and holding one of the Volume keys on the left side of the phone with the folder closed. The “Call rejected” message appears and the phone returns to the previous screen.

Viewing missed calls

If you fail to answer a call for any reason, the phone indicates a missed call by displaying a text notification on the screen. Additionally, if caller information is available, a Missed entry is created, and the screen displays the phone number of the last missed call.

When the display informs you of the missed call, press the  key to access the Recent Calls list, or the  key to clear the message and return to Standby mode.

To view the list of the missed calls, see “Missed” on page 60.

Options during a call

Your phone provides a number of functions that you can use during a call, you may not be able to use all of them at all times as many of these options are network services.

Press the **Menu** soft key during a call to access the following options:

Mute/Quit: allows you to switch your phone’s microphone off, so that the other person cannot hear you.

Example: You wish to say something to another person in the room but do not want the other person to hear you.

Calls: allows you to access the **Calls** menu. See page 60.

Phonebook: allows you to access the **Phonebook** menu. See page 66.

Silent/Quit: does not sound the key tones. It allows you to press keys without hearing annoying key tones during a call.

Send my #: sends DTMF (Dual Tone Multi-Frequency) tones of your phone number.

DTMF length: enables you to select **Long** or **Normal** DTMF tones. The system used by the bank or other service determines if you need short or long DTMF tones. If the service is digital, as most are, short DTMF tones will almost always work.

Call forwarding

When the **Call forward** menu (**Menu 1-6**) is enabled, your phone forwards incoming calls to another phone or voicemail centre that you have specified, even if your phone is off. For further details, see page 64.



Activating Call Forwarding does not affect outgoing calls made from your phone.

Call waiting

When the **Call waiting** menu (**Menu 1-7**) is enabled, you can answer an incoming call while you have a call in progress. See page 65 for further details.

When a waiting call is detected, the incoming call alert sounds, depending on your network, and a text notification displays.



To answer a waiting call:

1. Press the  key. The phone connects the calling person and places the current person on hold.
2. Press the  key again to switch between the two callers.
3. To end the call, press the  key or close the phone. All of the calls are disconnected.

Three-way calling

This feature enables you to conduct conference calls with two separate people at the same time. The phone records both of them into the Outgoing call log and you are billed airtime for each of the outgoing calls separately. Contact your service provider to activate Three-way Calling.

To make a three-way call:

1. During a conversation, enter the phone number for the third person and press the  key.
2. When the third person answers, press the  key again to begin your three-way call.

When one of the callers hangs up, you and the remaining caller stay connected. If you initiated the call and you hang up first, all three people are disconnected.

Entering text

There may be times when, you will need to enter text, such as when storing a name in Phonebook, or writing a text message or scheduling events on your calendar. You can enter alphanumeric characters into your phone by using your phone's keypad.

Your phone has the following text input modes:

- **T9 word:** allows you to enter English characters with only one keypress per character.
- **ABC:** allows you to enter alphabet characters by pressing the key labelled with the character you want until it displays.
- **123:** allows you to enter numbers.
- **Symbol:** allows you to enter many different symbols and special characters.

Note: T9 mode automatically compares your key presses to an internal linguistic database to determine the correct word.

Changing the text input mode

Example: Entering a name in Phonebook

1. In the text entry screen, press the **Mode** soft key.
2. Scroll to the mode you want to use by pressing the Up or Down key.

Note: If you want to exit the mode list without changing to a new mode, press the **C** key.

You can change between T9 word and ABC mode to enter English words. To include a symbol or number(s) between characters, Symbol and 123 modes are also available.

3. To select the highlighted mode, press the **OK** soft key.

The indicator for the text input mode appears on the display.

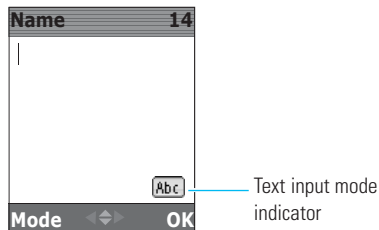

Using T9 word mode

To type a word in T9 word mode, press keys corresponding to the letters you need. Remember the following as you are typing:

1. Press keys on the phone just once per each letter.
For example, to enter "Hello," press the **4**, **3**, **5**, **5**, and **6** keys.
2. The word you are typing appears on the display. It may change with each key press.
3. Type to the end of the word before editing or deleting any keystrokes.

If the word you want to enter does not appear on the display, press the **0** key one or more times to display alternative word choices for the keys you have typed.

For example, both "Of" and "Me" have the sequence of **6** and **3**. The phone displays the most commonly used choice first.

4. Insert a space between words by pressing the **#** key.

To type words not found in T9 word mode, you need to change the text input mode to ABC mode.

Smart punctuation

You can insert periods, hyphens, and apostrophes by pressing the **1** key. T9 word mode applies rules of grammar to insert the correct punctuation. Notice that the **1** key is used twice in this example to display two punctuation marks:



Changing the letter-case

To shift the case of the next letter(s) that you type, press the ***** key. There are three cases:

- **T9 word**: Lower Case
- **T9 Word**: Initial Capital
- **T9 WORD**: Capitals Lock

Including a number

You can include a number between letters without exiting T9 word mode. Press and hold the number key.

Inserting a space

Press the **#** key to insert a space between words.

Scrolling

To move the cursor to the left or right through your text, press the Left or Right key.

Clearing letters and words

Press the **C** key once or repeatedly to clear letters one by one to the left. Press and hold the **C** key to erase all of the letters on the display.

Using ABC mode

When typing in ABC mode, you should press the key labeled with the letter you want:

- once for the first letter
- twice for the second letter
- and so on.











This method is called Multi-tap typing.

For example, you need to press the **2** key three times in succession to display the letter "C" and the **5** key two times to display the letter "K."

The cursor moves to the right when you press a different key. When entering the same letter twice or a different letter on the same key, just wait for a few seconds for the cursor to automatically move to the right, and enter the next letter.

Refer to the table below for the list of characters assigned to each key:

List of characters available

| Key | Characters in the Order Displayed |
|---|--|
|  | . @ , : ? - ; ' / () ! # % & * < > _ + = " \ { } \$ [] 1 |
|  | A B C 2 |
|  | D E F 3 |
|  | G H I 4 |
|  | J K L 5 |
|  | M N O 6 |
|  | P Q R S 7 |
|  | T U V 8 |
|  | W X Y Z 9 |
|  | 0 |

(Caps Lock mode)

Changing the letter-case

To shift the case of the next letter(s) that you type, press the * key. There are three cases:

- **abc**: Lower Case
- **Abc**: Initial Capital
- **ABC**: Capitals Lock

Inserting a space

Press the # key to insert a space between words.

Including a number

You can quickly enter a number between letters in ABC mode. Press and hold the number key.

Scrolling

To move the cursor to the left or right through your text, press the Left or Right key.

Clearing letters and words

Press the C key once or repeatedly to clear letters one by one to the left. Press and hold the C key to erase all of the letters on the display.

Using 123 mode

123 mode enables you to enter numbers into your text.

Press the keys corresponding to the digits you want to enter, and manually switch back to the text entry mode of your choice. See page 46 for changing the text input mode.

Using symbol mode

Symbol mode enables you to enter symbols into your text.

Press the Left or Right key to display more symbol sets. Press the key corresponding to the symbol you want to enter, and the phone automatically switches back to the text entry mode used just prior to selecting Symbol mode.

Using the menus

The phone offers a range of functions that allows you to tailor it to your needs. These functions are arranged in menus and sub-menus.

The menus and sub-menus can be accessed by scrolling or using the shortcuts.

Accessing a menu function by scrolling

1. In Standby mode, press the **Menu** soft key to access Menu mode.
2. Scroll using the Navigation keys to reach a main menu, for example, **Settings**. Press the **Select** soft key to enter the menu.
3. Find the menu you want, for example, **Display**, by scrolling using the Up and Down keys. Press the **Select** soft key to enter the menu.

If the menu you have selected contains sub-menus, such as **Language**, repeat this step.

4. Scroll using the Navigation keys to select the setting of your choice.
5. Press the **Save** soft key to confirm the chosen setting.

Notes:

- To return to the previous menu level, press the **C** key.
- You can exit the menu without changing the menu settings by pressing the  key.

Using shortcuts

The menu items, such as menus, sub-menus and setting options, are numbered and can be accessed quickly by using their shortcut numbers.

Note: The numbers assigned to each menu function are indicated on the list on the next page.

1. In Standby mode, press the **Menu** soft key to access Menu mode.
2. Enter the first digit of the shortcut number. Repeat this for each digit of the shortcut number.

Example: Changing the display language

Press the **6**, **2**, and **3** keys.

6 enters **Settings**, **2** selects **Display**, and **3** selects **Language**.

3. Scroll using the Navigation keys to select the setting of your choice.
4. Press the **Save** soft key to confirm the chosen setting.

List of menu functions

The following list shows the menu structure available and indicates the number assigned to each option.

1: Calls

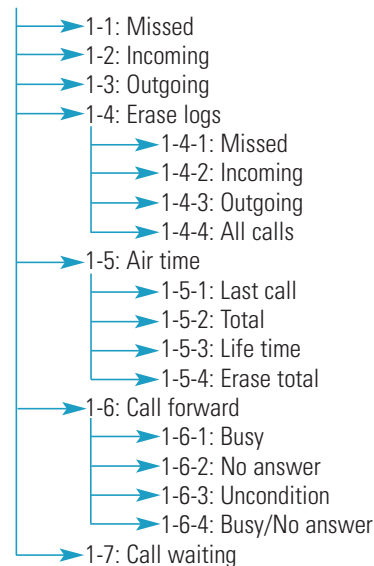

2: Phonebook



3: Messages

- 3-1: New message
- 3-2: Inbox
 - 3-2-1: Voice
 - 3-2-2: Card
 - 3-2-3: Phone
- 3-3: Outbox
 - 3-3-1: Card
 - 3-3-2: Phone
- 3-4: Erase msgs
 - 3-4-1: Voice notif.
 - 3-4-2: Inbox card
 - 3-4-3: Inbox phone
 - 3-4-4: Outbox card
 - 3-4-5: Outbox phone
 - 3-4-6: All messages
- 3-5: Msg setup
 - 3-5-1: Scroll timer
 - 3-5-2: Msg. reminder
 - 3-5-3: New message
 - 3-5-4: Canned msg.

4: Scheduler

- 4-1: View month
- 4-2: Jump to date
- 4-3: Alarm set
- 4-4: Calculator
- 4-5: Today
- 4-6: To do list
- 4-7: Memo pad
- 4-8: Countdown
- 4-9: World time

5: Entertainment

- 5-1: Music box
 - 5-1-1: Voice calls
 - 5-1-2: Messages
 - 5-1-3: Alarm/Scheduler
- 5-2: Image box
 - 5-2-1: Opening
 - 5-2-2: Closing
 - 5-2-3: Wallpaper
- 5-3: Games
- 5-4: MP3 player
- 5-5: Memory status
 - 5-5-1: Total
 - 5-5-2: Music
 - 5-5-3: Image

6: Settings

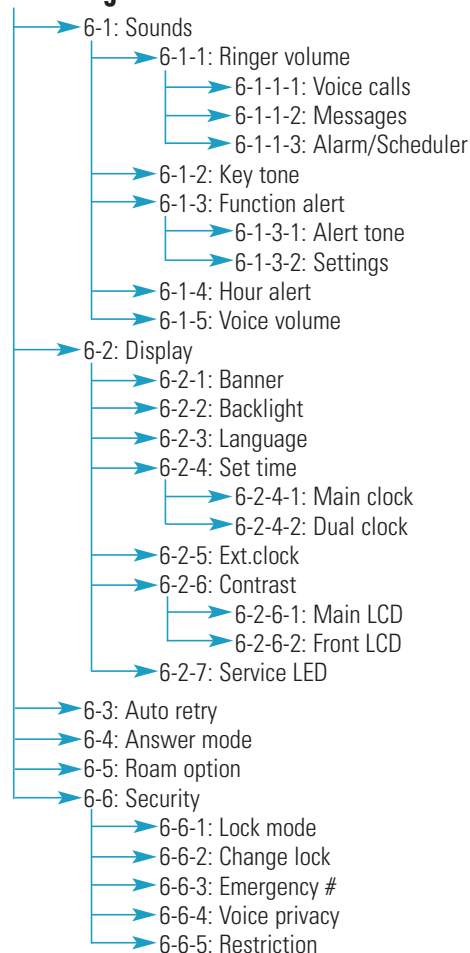

6: Settings (continued)

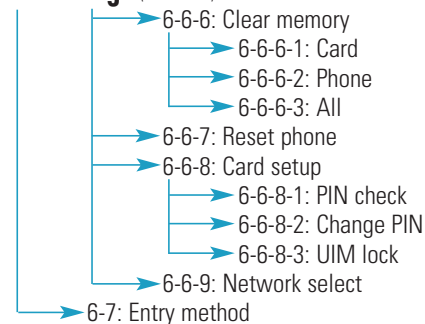

7: Camera

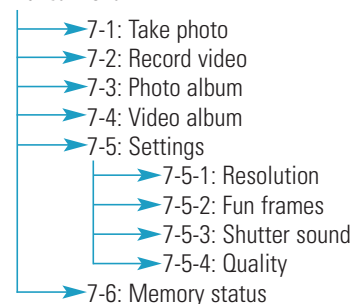

* Available only when you use a UTK UIM card that provides additional services. For further details, see your UTK UIM card instructions.



You can use the **Calls** menu to:

- view and dial the last missed, outgoing or incoming numbers.
- erase the numbers in the call logs.
- view the duration of calls.
- set the phone to receive a second call or to forward incoming calls to a preset number.

Missed *(Menu 1-1)*

If Caller Line Identification is available, your phone keeps a list of the last 20 incoming calls that you failed to answer. Contact your service provider for the availability.

1. Press the Up or Down key to find a number or name, if saved in your Phonebook.
2. Press the **Select** soft key to select the highlighted number. The dialed number or name, if stored in Phonebook, displays.

| 3. To | Press the |
|----------------------------|--|
| place a call to the number |  key. |
| use the menu options | Menu soft key. For details, see the next page. |
| view other calls | Navigation keys. |
| return to Standby mode |  key. |

When you access the menu options, the following options are available:

Talk: dials the number.

Save: allows you to save the number in Phonebook.

Prepend: allows you to add an area code or feature code to the number before calling the number.

Erase: allows you to erase the number.

Incoming *(Menu 1-2)*

This menu lets you view up to 20 of the last calls you received if you are a subscriber to the Caller Line Identification service. Contact your service provider for more information about this service. When you access this menu, the list of the incoming calls displays.

For further details about scrolling through the list and accessing the call log, see “Missed” on the previous page.

Outgoing *(Menu 1-3)*

The phone stores up to 20 of the last numbers you dialed. When you access this menu, a list of the outgoing calls displays.

For further details about scrolling through the list and accessing the call log, see “Missed” on page 60.

Erase logs *(Menu 1-4)*

In this menu, you can erase the entries stored in each of the three call logs; missed, incoming, and outgoing calls. You can also erase all of your call log entries at one time by selecting **All calls**.

When a confirming message appears, select **Yes** to erase the logs. If you want to cancel the selection, select **No**.

Air time *(Menu 1-5)*

Your phone records the amount of air time, or talk time, used. Using this menu, you can view the number of the calls to or from your phone and the air time for all of the calls. You can easily erase the air time record at any time.

Note: This feature is not intended to be used for billing purposes.

The following options are available:

Last call: shows the air time of the last call.

Total: shows the number of all calls you made or received and the total duration of the calls since the air time counter was last set to zero by using the **Erase total** option.

Life time: shows the number and total duration of all calls you made or received your phone since the phone was shipped from the factory.

Erase total: erases the “Total” air time measurement and resets the air time counter.

Call forward *(Menu 1-6)*

This network service allows incoming calls to be forwarded to another number.

Note: This menu is only available when your network operator supports it. Contact your service provider to check the availability.

The following options are available:

Busy: Calls are forwarded when you are already on the phone.

No answer: Calls are forwarded when you do not answer the phone.

Uncondition: Calls are always forwarded.

Busy/No answer: Calls are forwarded when you are already on the phone or do not answer.

To set your forwarding options:

1. Choose the type of call forwarding by pressing the Up or Down key and press the **Select** soft key.
2. Select **Enable** and press the **Save** soft key.
3. Enter the area code and phone number where your calls will be forwarded.
4. Press the **Send** soft key. The phone sends your setting to your network.

Once Call Forwarding is enabled, a notification text appears to inform you that your calls will be diverted. It will also inform you each time a call is forwarded.

To deactivate the call forward setting:

1. Choose the call forwarding option and press the **Select** soft key.
2. Select **Disable** and press the **Save** soft key.

Call waiting *(Menu 1-7)*

The Call Waiting feature alerts you of incoming calls while you are on a call.

To enable the feature, select **Enable** by pressing the Up or Down key and press the **Save** soft key. The phone sends your setting to your network.

When Call Waiting is enabled, you can respond to an incoming call by pressing the  key while you are on a call. This puts the first caller on hold and answers the second call. For further details, see page 43.

To deactivate the call waiting setting, select **Disable** and press the **Save** soft key.

Phonebook

You can store phone numbers and their corresponding names in the memory of your UIM card and the phone. The UIM card and phone's memory, although physically separate, are used as if they were a single entity, called Phonebook.

The capacity of the card memory may vary depending on your card's manufacturer.

Find *(Menu 2-1)*

This menu allows you to find an entry using a person's name, entry number, group name or memory location.

Note: You can quickly access this menu by pressing the **Find** soft key in Standby mode.

To change the finding method, press the Up key and press the Left or Right key until the option you want to use displays; **By name**, **By entry**, **By group**, or **By storage**.

Finding an entry by name

When you select this method, all of the Phonebook entries appear in alphabetical order.

1. If necessary, press the Left or Right key to scroll to **By name**.
2. If necessary, press the Down key to highlight the name input box.

3. Enter the first few letters of the name you want to find. You can enter characters using ABC mode by default..
4. If necessary, press the Up or Down key to scroll through the entries.
5. When an entry highlights:
 - Press the  key to place a call to the entry's speed-dial number.
 - Press the **Menu** soft key to access the following options:
 - **Edit**: edits the entry's phone number, name, location number and other information.
 - **Erase**: erases the entry.
 - **Add new**: adds a number to Phonebook. You can create a new entry or add it to an existing entry. For more information about how to add a number, see page 70.

- Press the **OK** soft key to select the entry. Information about the entry displays. Move to each item by pressing the Up or Down key.

Press the **Menu** soft key to use one of the following options:

- **Talk**: dials the number labelled as a speed-dial number.
- **Edit**: allows you to change the item.

- **Copy**: allows you to copy a number to another memory location. For an entry stored in the phone's memory, this option is shown only when you select a number, such as **Home**, **Office**, **Mobile**, **Pager**, or **Fax**.

- **Erase**: erases the entry. If you select one of the numbers for the entry, only the number is erased.

- Press the **C** key to return to the previous screen.
- Press the  key to exit this menu.

Finding an entry by entry number

When you select this method, all of the Phonebook entries appear in numeric order of the location numbers.

1. Press the Left or Right key to scroll to **By entry**.
2. Press the Down key to highlight the number input box.
3. Enter the location number of the entry you want to find.
4. Follow the procedure from step 4 on page 67.

Finding an entry by group

When you select this method, a list of the Phonebook entries in a group appears.

1. Press the Left or Right key to scroll to **By group**.
2. Press the Down key to move to the group selection field.
3. Press the Left or Right key to scroll through the groups.

Each time you select a group, a list of the associated entries displays.

4. Follow the procedure from step 4 on page 67.

Finding an entry by storage

When you select this method, a list of the Phonebook entries in the UIM card appears first.

1. Press the Left or Right key to scroll to **By storage**.
2. Press the Down key to move to the memory selection field.
3. Press the Left or Right key to scroll through the memory, **Card** and **Phone**.

Each time you select a memory, a list of the associated entries displays.

4. Follow the procedure from step 4 on page 67.

Add *(Menu 2-2)*

This menu allows you to add a new entry to your Phonebook by saving a phone number, an e-mail address or a memo.

Adding a new entry using a number

In the Phone memory, a name can contain up to 5 numbers in different categories; Home, Office, Mobile, Pager, and Fax. You can save only one number with a name in the Card memory.

1. After accessing the **Add** menu (**Menu 2-2**), select **Number** from the pop-up list and press the **OK** soft key.
2. Enter a number you want to save and press the **Save** soft key.
3. Press the **Save** soft key to accept **New entry**.
4. Enter a name and press the **OK** soft key.

For more information about how to enter characters, see page 45.

5. Your phone shows the entry information. Press the Up or Down key to scroll through the items.

- **Name:** Press the **Edit** soft key to change the name you entered in step 4, if necessary. You can enter a name in this step if one has not already been entered.
- **Storage:** Shows the memory where the number is stored. The card memory is automatically selected for storing the number.
- **Location number:** The first available location displays. If you need to, enter the location number using the number keys or press the Left or Right key until the location number you want to use appears.
- **Number:** Shows the number you entered in step 2. You can change the number or insert a pause using the **Pause** soft key.

6. To save the number in the card, skip to step 10.

To save it in the phone's memory, highlight the storage or location number field and press the **Phone** soft key. Continue the next steps.

7. Choose a type icon, **Home**, **Office**, **Mobile**, **Pager**, or **Fax** using the Navigation keys and press the **Select** soft key.

8. Press the Up or Down key and change the setting or enter more information, if necessary.

- **Name:** Shows the entry name.
- **Storage:** Shows the memory where the number is stored.
- **Location number:** Shows the location number.
- **Home/Office/Mobile/Pager/Fax:** You can add numbers for each category or change the current number.
- **E-Mail/E-Mail2:** Press the **Edit** soft key to enter an e-mail address. For more information about how to enter characters, see page 45.
- **ETC:** Press the **Edit** soft key to add a memo about the person.
- **Load image:** Allows you to assign one of the photos you took using the camera as a caller ID image to be displayed when you receive a call from the selected number.
- **Speed dial:** Select the category of the number you want to use for speed-dialing, by pressing the Left or Right key .
- **Group:** Select one of the default relation groups, where the entry is included. Grouping the entries enables you to search for a number in the group. See page 69.
- **Ringer:** Select a unique ringer melody for the entry. By selecting a different tone for each entry, incoming voice calls having a caller ID can be distinguished from those that do not.

9. Repeat step 8 until you complete the contact information of the entry.

10. Press the **Save** soft key to save the entry.

After storing, the phone displays the memory status of Phonebook for a few seconds and goes to the Phonebook list.

Saving a phone number from standby mode

1. In Standby mode, enter a number you want to save.

Or, press the  key to end the call. The call time and the phone number display.

2. Press the **Save** soft key.

3. Enter a name and press the **OK** soft key.

For more information about how to enter characters, see page 45.

4. Follow the procedure from step 5 on page 71.

Adding a number into an existing entry

You can store up to 5 numbers for a name saved in the phone's memory by assigning them to the different types.

1. After accessing the **Add** menu (**Menu 2-2**), select **Number** from the pop-up list and press the **OK** soft key.

2. Enter a number you want saved and press the **Save** soft key.

3. Press the Up or Down key to select **Find** and press the **Save** soft key.
4. Find the name you want using the Up and Down keys and press the **OK** soft key.
5. Select a type icon by pressing the Navigation keys and press the **Select** soft key.
6. Follow the procedure from step 8 on page 72.
7. When the confirmation message to overwrite the entry appears, select **Yes** and press the **Select** soft key.

Adding a new entry using an e-mail address

You can store an e-mail address as a Phonebook entry.

1. After accessing the **Add** menu (**Menu 2-2**), select **E-mail** from the pop-up list and press the **OK** soft key.
2. Enter the e-mail address and press the **OK** soft key.

For more information about how to enter characters, see page 45.

3. Press the **Save** soft key to accept **New entry**.

Note: To add the address to an existing entry, select **Find**. Find the name from the Phonebook list and press the **OK** soft key.

4. Enter a name and press the **OK** soft key.
5. Follow the procedure from step 8 on page 72.

Adding a new entry using a memo

You can make a memo about a person as a Phonebook entry.

1. After accessing the **Add** menu (**Menu 2-2**), select **ETC** from the pop-up list and press the **OK** soft key.
2. Enter a memo and press the **OK** soft key.

For more information about how to enter characters, see page 45.

3. Press the **Save** soft key to accept **New entry**.

Note: To add the memo to an existing entry, select **Find**. Find the name from the Phonebook list and press the **OK** soft key.

4. Enter a name and press the **OK** soft key.
5. Follow the procedure from step 8 on the page 72.

Group set *(Menu 2-3)*

This menu allows you to change a group's name.

1. Press the Up or Down key to select the group you want to rename and press the **Select** soft key.
2. Press the **C** key to erase the old group name.
3. Enter a name.

For more information about how to enter characters, see page 45.

4. Press the **OK** soft key to save the new name.

My phone # *(Menu 2-4)*

This menu shows your phone number.

To change the phone number:

1. Press the **Edit** soft key when the number displays.
2. Enter a new phone number and press the **Save** soft key.

Messages

In this menu, you can write new SMS (Short Message Service) messages and check your incoming messages.

Your phone can receive voice mail notifications, text messages, and web messages from your web server. Your phone can also send text messages if your system supplier provides this service.

Incoming messages are received even when your phone is in Lock mode. To access the message, you need to unlock the phone.

If you receive an incoming message during a call conversation, your phone sounds an alert tone or vibrates, depending on your sound settings.

Note: You can quickly enter the **Messages** menu by pressing the Left key in Standby mode.

New message *(Menu 3-1)*

You can create short text messages and send them to multiple mobile phones.

1. Enter the message contents and press the **OK** soft key.

For more information about how to enter characters, see page 45.

You can use up to 20 canned messages by pressing the **Mode** soft key and selecting **CannedMsg..** For details, see page 84.

2. Select one of the following options and press the **OK** soft key:
 - **Send & Save:** allows you to save a copy of the message and then send the message to the required destination. You can read the message in your Outbox.
 - **Send only:** allows you to send the message. The message will be deleted after sending.
 - **Save only:** allows you to save the message so that it can be sent later. You can read the message in your Outbox.

3. Enter a phone number.

If you press the **Find** soft key and select **Phonebook**, you can search your Phonebook for a number. For details, see page 66.

4. To send the message to multiple destinations, press the Down key and enter another number.

Repeat this step to add more destinations. You can send the message to up to 10 destinations at one time.

5. When you finish entering the numbers, press the **OK** soft key to send or save the message.

Your phone informs you whether or not the message was successfully sent, and returns to the Message menu screen.

Inbox *(Menu 3-2)*

Your phone can store SMS messages and their corresponding Caller ID in your UIM card and phone's memory. If your memory is full, the screen displays a text notification and rejects additional incoming messages until you erase the obsolete ones.

Voice

When you receive a voice mail message, the Voice mail icon (📞) and the corresponding text notification displays. Press the **↶** key to place a call to the voice mail centre. Then follow the voice prompts from the system to listen to the message.

Note: You can quickly access your voicemail server by pressing and holding the Left key in Standby mode.



You can also check your voice messages by accessing the **Voice** menu (**Menu 3-2-1**).

For further details about the voice mail service and its availability, contact your service provider.

Text messages

When the phone receives a text message, the New SMS message icon () and a text notification with the call back number appear. Press the **OK** soft key to view the message immediately.

When you access the **Card** menu (**Menu 3-2-2**) or **Phone** menu (**Menu 3-2-3**), a list of the received message displays. An icon displayed on the list shows the message's status:

-  : displays when you have read the message.
-  : indicates that a duplicate message was sent.
-  : means that the message is urgent.

Press the Up or Down key to scroll to the message you want and press the **View** soft key. The phone displays the contents. If necessary, press the Up or Down key to scan through the message.

While viewing a message, press the **Menu** soft key to use the following options:

Reply: allows you to send a reply message to the sender.

Forward: allows you to send the message to other people.



Call/Save: shows the list of the sender's number, the callback number and numbers from the message text, if any. Press the  key to dial the selected number. To save it in your Phonebook, press the **Save** soft key.

Erase: erases the message from your Inbox.

Outbox (Menu 3-3)

Your phone can store your outgoing messages in your UIM card and phone's memory.

When you access the **Card** menu (**Menu 3-3-1**) or **Phone** menu (**Menu 3-3-2**), a list of the sent messages display. An icon displayed on the list shows the message's status:

-  : indicates that the message was successfully delivered.
-  : indicates that the message was not sent.

Press the Up or Down key to scroll to the message you want and press the **View** soft key. The phone displays the contents along with the destination number. If necessary, press the Up or Down key to scan through the message.

While viewing a message, press the **Menu** soft key to use the following options:

Resend: allows you to send the message to other people.

Call/Save: shows the list of the destination number and numbers from the message text, if any. Press the  key to dial the selected number. To save it in your Phonebook, press the **Save** soft key.

Erase: erases the message from your Outbox.

Erase msgs *(Menu 3-4)*

Using this menu, you can erase all of the messages in each message box; voice notification, card inbox, phone inbox, card outbox and phone outbox.

You can also erase all of the messages at one time using the **All messages** option.

Msg setup *(Menu 3-5)*

Using this menu, you can set up various options for receiving or sending messages.

Scroll timer *(Menu 3-5-1)*

If an incoming message is too long for the display, the phone displays it by scrolling the screen automatically. You can set the time interval the phone scrolls to the next screen, from 1 to 5 seconds.

When this option is set to **Off**, you need to manually scroll to the next screen using the Up or Down key.

Msg. reminder *(Menu 3-5-2)*

When a message is received, your phone alerts you by sounding the specified ringer. You can set how often this will happen.

Off: The phone doesn't alert you after you receive an incoming message but the New Message icon appears.

Once: The phone alerts you just once when you receive an incoming message.

Every 2 min: The phone alerts you every 2 minutes when you receive an incoming message.

New message *(Menu 3-5-3)*

You can set up the following options as default settings when creating a new message:

Priority: allows you to set the priority level of the messages from **Normal**, **Urgent**.

Canned msg. *(Menu 3-5-4)*

Your phone has 11 preset messages to enable you to use them when writing a new message.

You can change them, if necessary, and add up 9 messages.

1. Press the Up or Down key to highlight the message you want to change.

To add a new message, select an empty location.

2. Press the **Select** soft key.

3. Clear the existing message using the **C** key, if necessary, and enter a new message.

For further details about how to enter text, see page 45.

4. Press the **OK** soft key to save the message.

Scheduler

The Scheduler feature enables you to:

- keep track of important dates and events.
- set the phone to ring at a specified time.
- use the phone as a calculator.
- create a list of things to do.
- set and count down to D-Day.
- check the current time in another part of the world.

Note: When you are out of your service area, you cannot use some of the features in the **Scheduler** menu.

View month *(Menu 4-1)*

This menu allows you to view the current month, as well as the past or future months in calendar format. You can be alerted by the Calendar function before an event commences.

When you access this menu, the current day is automatically selected and indicated by a blue box on the calendar.

Note: You can quickly enter this menu by pressing the Right key in Standby mode.

Selecting a day on the calendar

- You can move to the next or the previous day by pressing the Left or Right key.
- You can move up or down the Calendar by week by pressing the Up or Down key.
- You can view the next or previous month by using the Volume keys on the left side of the phone.

On the calendar, press the **Menu** soft key to use the following options:

View: allows you to view the scheduled events of the day.

Add new: allows you to add a new event on the day.

Scheduling an event

You can schedule up to 9 events for one day and 20 events total.

1. Select a day from the calendar, referring to “Selecting a day on the calendar,” and press the **OK** soft key.
2. Enter your event information and press the **OK** soft key to accept your input.

For further details about how to enter characters, see page 45.

3. Enter the Start time and date using the numeric keys and press the Down key.

Notes:

- You need to enter the time 12-hour format.
- You can move through the input fields using the Left and Right keys.

4. Enter the End time and date using the numeric keys and press the Down key.
5. Specify when an alarm alerts you to your event, by pressing the Left or Right key. When you select **No alarm**, the phone does not ring the alarm.
6. Press the **Save** soft key to save your event.

Viewing your schedule

Days with scheduled events are indicated by a box on the calendar when you access the **View month** menu (**Menu 4-1**). Select one of them and press the **OK** soft key. The first event displays.

Highlight to the event you want to view by pressing the Left or Right key. If necessary, press the Down key to display the end time of the event.

While viewing an event, press the **Menu** soft key to use the following options:

Add new: allows you to add a new event.

Edit: allows you to edit the event.

Erase: erases the event.

Erase all: erases all of the scheduled events.

Jump to date *(Menu 4-2)*

This feature allows you to specify a date so that you can easily access the day without scrolling through the calendar.

1. Enter the date using the numeric keys and press the **Save** soft key.

Notes: You can move through the input fields using the **Left** and **Right** keys.

2. When the date you entered highlights on the calendar, press the **Save** soft key to access it.

For further details about scheduling or viewing events, see “View month” on page 85.

Alarm set *(Menu 4-3)*

This menu allows you to set the alarm to ring at a specific time.

To set the alarm:

1. Select the alarm frequency option by pressing the Navigation keys.
 - **Once:** The alarm rings only once and is then deactivated.
 - **Daily:** The alarm rings every day at the same time.

2. Press the **Save** soft key.
3. Enter the time for the alarm to ring by using the numeric keys.

Notes:

- You can move through the input fields using the **Left** and **Right** keys.
- You must enter the hour 12-hour format.

4. Press the **Save** soft key to save the setting.

To stop the alarm when it rings, open and close the folder or press any key.

To deactivate the alarm, access the **Alarm set** menu, select **Off**.

Calculator *(Menu 4-4)*

Using this feature, you can use the phone as a calculator. The calculator provides the basic arithmetic functions; addition, subtraction, multiplication and division.

To perform a calculation:

1. Enter the first number using the numeric keys.

Notes:

- To erase any mistakes or clear the display, press the **C** key.
- Use the ***** key to enter a decimal point and the **#** key to change the sign of a number to a negative (-).

2. Select the operation for your calculation by pressing the Navigation keys according to the illustration on the display; + (add), - (subtract), **x** (multiply), **÷** (divide).
3. Enter the second number.
4. To view the result, press the **OK** soft key.
5. Repeat steps 1 to 4 as many times as required.

Today *(Menu 4-5)*

You can schedule up to 9 events for the current day, indicating each event's starting and ending time. Events scheduled on future dates automatically appear on your Today display on that particular day.

For further details about scheduling and viewing events, see "View month" on page 85.

To do list *(Menu 4-6)*

This feature allows you to enter a list of tasks you need to do and assign both a priority and a deadline to them. You can store up to 20 tasks.

Creating a to do item

1. Enter the task contents and press the **OK** soft key.

For more information about how to enter characters, see page 45.

2. Select High or Low priority using the Left or Right key and press the Down key.
3. Enter the time and date when your task needs to be done using the numeric keys.

Notes:

- You can move through the input fields using the Left and Right keys.
- You must enter the hour in 12-hour format.

4. Press the **Save** soft key to save the task.

Viewing to do list

When you access the **To do list** menu (**Menu 4-6**), the first task displays along with the deadline and the associated priority highlighted; ★1 for high priority or ★2 for low priority.

Scroll to the task you want to view by pressing the Left or Right key.

While viewing a task, press the **Menu** soft key to use the following options:

Add new: allows you to add a new task.

Edit: allows you to edit the task.

Erase: erases the task.

Erase all: erases all of the tasks.

Memo pad *(Menu 4-7)*

This feature allows you to make memos of important things you need to remember.

Writing a new memo

1. Enter what you need to remember.

For further details about how to enter characters, see page 45.

2. Press the **OK** soft key to save the memo.

Viewing a memo

The list of your memos displays when you access the **Memo pad** menu (**Menu 4-7**). To view details, press the Navigation keys to scroll to the memo you want to view from the list and press the **Select** soft key.

While viewing a memo, press the **Menu** soft key to use the following options:

Add new: allows you to add a new memo.

Edit: allows you to edit the memo.

Erase: erases the memo.

Erase all: erases all of the memos.

Countdown *(Menu 4-8)*

This menu helps you know how much time it takes for you to do something or how many days, hours and minutes until a specific event occurs. You can create up to 20 Countdown timers using this feature.

Creating a countdown timer

1. Enter a name for your Countdown timer and press the **OK** soft key.

For more information about how to enter characters, see page 45.

2. Enter the time and date you want to count down from.

Notes:

- You can enter between 1981 and 2099 for the year.
- You can move through the input fields using the Left and Right keys.
- You must enter the hour in 12-hour format.

3. Press the **Save** soft key to save the timer.

Viewing a countdown timer

The first Countdown timer displays when you access the **Countdown** menu (**Menu 4-8**).

Scroll to the timer you want to view by pressing the Left or Right key.

While viewing a timer, press the **Menu** soft key to use the following options:

Add new: allows you to create a new timer.

Edit: allows you to edit the timer.

Erase: erases the timer.

Erase all: erases all of the timers.

World time *(Menu 4-9)*

You can use this menu to find out what time it is in another part of the world and apply the DST (Daylight Saving Time) to a time.

Press the Navigation keys to scroll to the time zone you want to check.

To apply the Daylight Saving Time:

1. After selecting the time zone you want to apply the DST, press the **DST** soft key.
2. Select **Yes** using the Left or Right key and press the **Select** soft key. The DST icon appears on the left of the time.

To cancel the setting, select **No**.

Entertainment

Using the **Entertainment** menu, you can download and enjoy various contents, such as images, sounds, games or MP3 files from the Wireless Web. You can also manage the downloaded contents.

Music box *(Menu 5-1)*

This menu allows you to set the unique ringer melodies for the following items. You can select one of the default melodies or ones downloaded from the Wireless Web or using the PC link programme:

Voice calls: allows you to select a ringer for incoming voice calls.

Note: You can quickly change the call ringer in Standby mode. Press and hold the *** key**.

Messages: allows you to have a ringer for incoming voice mail, text messages and web alerts.

Alarm/Scheduler: allows you to have a ringer for alarm settings and the scheduler alarm.

To select a melody:

1. Select an item you want and press the **Select** soft key.
2. Select the ringer category you want using the Left and Right keys and press the Down key.

When you select **Messages** in step 1, skip to step 3.

3. Scroll through the ringers using the Left and Right keys. After you change it, it sounds.
4. Press the **Select** soft key when you find the ringer you want.

To erase a melody:

1. On the list of the downloaded melodies, **My melody** or **MP3 melody**, scroll to the melody you want to erase and press the **Erase** soft key.
2. When a confirmation message appears, select **Yes** and press the **Select** soft key.

Image box *(Menu 5-2)*

This menu allows you to change the background image to be displayed in Standby mode or when the phone is turned on or off. You can also erase downloaded images or photos.

The following options are available:

Opening: You can select an image to display when you turn the phone on.

Closing: You can select an image to display when you turn the phone off.

Wallpaper: You can select an image to display on the idle screen.

To select an image:

1. Select an item you want and press the **Select** soft key.
2. Select the image category you want and press the **Select** soft key.

You can select one of the default images, ones you downloaded from the web or photos you took..

3. Scroll through the images using the Navigation keys.
4. Press the **Select** soft key when you find the image you want.

To erase an image:

1. On a image list of the **My image**, or **Photo**, scroll to the image you want to erase and press the **Erase** soft key.
2. When a confirmation message appears, select **Yes** and press the **Select** soft key.

Note: When you delete a photo you took in this menu, it is also deleted from the Photo album.

Games *(Menu 5-3)*

You can enjoy games using your phone.

To start a game:

1. Press the Up or Down key to scroll to one of the games and press the **Select** soft key.
2. Press one of the Navigation keys or the right soft key.

The phone displays the following options:

- **NEW GAME**: allows you to start a new game.
 - **HIGH SCORE**: shows you the high score table.
 - **HELP/KEY INFO**: gives you the key helper screen to play the game.
 - **CONTINUE**: allows you to continue the last game you played. This option is activated only when you have played a game.
3. Select **NEW GAME** or **CONTINUE** using the Up or Down key and press the right soft key.
 4. When **START GAME** or **START** is highlighted, press the right soft key.

To use the following options, select **OPTION**. Press the Up or Down key to scroll to an option and change the setting using the right soft key:

- **DIFFICULTY**: allows you to change the game level.

- **SOUND**: allows you to turn the game sound on or off.
- **VIBRATION**: allows you to turn the vibration on or off.
- **BACK**/: goes back to the previous screen. You need to select this option after changing the options.

Note: The available options may be different depending on the selected game.

5. While playing a game:

| To | Press the |
|-----------------------|--|
| pause/resume the game | C key. |
| exit the game |  key. |

Note: The key operation may vary depending on the selected game. Please use the on-screen help.

MP3 player *(Menu 5-4)*

Your phone provides you with the MP3 player function to enable you to enjoy MP3 music files.

Before using the MP3 player, you need to download MP3 files stored in your PC to your phone's memory through the MP3 manager programme downloaded at www.samsung.com/id.

Notes:

- Your phone can store MP3 files of up to 16 MB.
- You can download MP3 files with a transmission speed of 40 to 128 Kbps.

Playing MP3 files

You can play all of the MP3 files stored in your phone or the selected file(s).

To play all of the files in the phone:

1. Press the **⏮** key from the MP3 player screen.
2. You can use the following options while playing a file:

| To | Press the |
|-----------------------------------|-----------------|
| pause or resume playing | ⏮ key. |
| access the previous file | Left key twice. |
| skip to the beginning of the file | Left key. |

| To | Press the |
|---------------------------|--|
| skip to the next file | Right key. |
| change the repeating mode | Down key until a repeat mode icon appears. <ul style="list-style-type: none"> • 🔁: repeats the current file. • 🔁: repeats all of the files you selected. • 🔁: repeats all of the files. • 🔁: shuffles the files. |
| adjust the volume | Volume keys. |
| stop playing | Stop soft key or C key. |
| exit the MP3 player | End soft key. |

To play a file:

1. Press the Up key to view the file list.

When you press the **Option** soft key, the following options are available:

- **Multi-select**: plays all files you selected. For details, see page 102.
- **Erase**: deletes the file.
- **Erase all**: deletes all files.
- **Visual effect**: allows you to select an image shown on the screen while a file is playing.
- **File info**: allows you to view information about the file, such as the name, date when the file was downloaded, size and format.

2. Select a music file you want using the Up and Down keys and press the **Play** soft key.

For details about using the keys while playing the file, see page 100.

To play the selected files:

1. Press the Up key to view the file list.
2. Press the **Option** soft key and select **Multi-select**.
3. Select the file you want using the Navigation keys and press the **Check** soft key or **✳** key. Repeat this step to select more files.
4. Press the **Play** soft key.

For details about using the keys while playing files, see page 100.

Notes:

- You can receive a call while an MP3 file is playing. After ending the call, the phone returns to Play mode.
- When you receive a message while an MP3 file is playing, a warning tone beeps and the playing continues.
- When the alarm time expires while an MP3 file is playing, the file pauses and the alarm rings. After you stop the alarm, the phone returns to Play mode.

Memory status *(Menu 5-5)*

This menu allows you to check the amount of the memory being used or memory remaining available for downloaded contents, such as melodies, images, games and other applications.

Total: shows the total space including the used and free space.

Music: shows the list of downloaded music files, such as bells or melodies.

Image: shows the list of downloaded image files, including pictures and animated images.

You can also delete obsolete contents from the content list to free memory space to store a new one.

Settings

Many different features of your phone can be customised to suit your preferences.

Sounds *(Menu 6-1)*

You can use this menu to customise various sound settings, such as the:

- ringer volume.
- key tone and voice volume.
- tone that sounds while using the phone's functions.
- tone that alerts you every hour on the hour.

Ringer volume *(Menu 6-1-1)*

This menu allows you to adjust the ringer volume for the following items:

Voice calls: allows you to adjust the ringer volume for the incoming calls.

Note: You can adjust the volume using the Volume keys on the left side of the phone in talk mode.

Messages: allows you to adjust the ringer volume for incoming messages.

Alarm/Scheduler: allows you to adjust the ringer volume for alarm settings and the scheduler alarm.

Press the Navigation keys to adjust the volume level or select the type. The following options are available:

Silent: The phone does not sound a ring.

1 Beep: The phone sounds a beep.

Vibrate: The phone switches to Vibration mode. An incoming call vibrates the phone.

Level 1 ~ 5: You can adjust the volume level. The graphic shows the volume level; the more bars, the louder the volume.

Key tone *(Menu 6-1-2)*

This menu allows you to select the type of the key tone that the phone sounds each time you press a key.

Function alert *(Menu 6-1-3)*

Your phone gives audible alerts (beeps) at a specified time to inform you that certain things have happened while using your phone.

Alert tone

In this menu, you can select a tone for the function alerts.

Select one of the three alert tones.

Settings

You can turn on or off each alert. Press the **Check** soft key to place a check mark in front of the alert you want to turn on. You can delete the check mark by pressing the **Uncheck** soft key.

The following alerts are available:

Select/Saving: When this alert is selected, the phone sounds an alert when you save your selection or change a menu function.

Cancel/Warning: When this alert is selected, the phone sounds an alert when you cancel your selection or change when a confirming message appears.

Folder: When this alert is selected, the phone sounds an alert when you open or close the phone's folder.

Connect: When this alert is selected, the phone sounds a connect tone when your call is connected to the system.

Disconnect: When this alert is selected, the phone sounds a disconnect tone when a call is disconnected.

Power on/off: When this alert is selected, the phone sounds an alert when you turn the phone on or off.

Silent mode: When this alert is selected, the phone sounds an alert when you exit Manner mode.

Hour alert *(Menu 6-1-4)*

You can set your phone to sound an alert every hour on the hour.

1. Enter the time period when the phone uses the hour alert using the number keypad.
2. Press the Down key and select **On** by pressing the Up or Down key.
3. Press the **Save** soft key.

If you want to deactivate the hour alert, select **off**.

Voice volume *(Menu 6-1-5)*

This menu enables you to adjust the voice volume of the earpiece.

Press the Navigation keys or the Volume keys on the left side of the phone to adjust the volume. The graphic shows the volume level; the more bars you see, the louder the volume.

Note: During a call, you can adjust the volume using the Volume keys.

Display *(Menu 6-2)*

The Display feature enables you to:

- create your own greeting.
- set the length of time for the backlight.
- change the display language.
- set the current time and date.
- change the clock type for the external display.
- turn the service light on or off.
- adjust the contrast of the display.

Banner *(Menu 6-2-1)*

This menu allows you to set a banner message to display at the bottom of the display in Standby mode.

To change the banner:

1. If necessary, press the **C** key to clear the old message.
2. Enter a new banner message using the alphanumeric keys.

For more information about how to enter characters, see page 45.

3. When you finish entering the message, press the **OK** soft key to save it.

Backlight *(Menu 6-2-2)*

In this menu, you can select the length of time the backlight remains on.

After the last key is pressed or you open the folder, the backlight remains on for a specified period of time and then turns off if no keys are pressed. Remember that the backlight use drains your battery faster.

Language *(Menu 6-2-3)*

You can change the language of the menu display and key input. Select **Indonesian**, **English**, or **Chinese MMI**.

Set time *(Menu 6-2-4)*

This menu allows you to set the current time and date. The following options are available:

Main clock

The current time, if set, displays. In a service area, your phone automatically receives time information from the network.

1. Enter the current time and date using the number keypad.

The month, day, hour and minute must each be entered using 2 digits and the year requires all four digits.

Notes:

- You need to enter the time 12-hour format.
- You can move through the input fields using the Left and Right keys.

2. When you are finished, press the **Save** soft key.

Dual clock

You can choose two time zones to be displayed when you select **Dual clock** for the wallpaper image (**Menu 5-2-3**); see page 96.

To select time zones for the dual clock:

1. When **Location** highlights, press the Down key.
2. Select the time zone for the left clock by pressing the Left or Right key and press the Down key.
3. Select the time zone for the right clock by pressing the Left or Right key.
4. Press the **Save** key.

To apply the daylight saving time:

1. When **Location** highlights, press the Left or Right key to display **Summer time**. Press the Down key.
2. Select **On** to use the daylight saving time for the left clock. Otherwise, select **Off**.
3. Press the Down key and repeat step 2 for the right clock.
4. Press the **Save** key.

Ext.clock (Menu 6-2-5)

You can change the type of clock to be shown on the external display in Standby mode.

Select one of the four options; **Digital clock** and **Analog clock 1** through **Analog clock 3**.

Contrast (Menu 6-2-6)

You can adjust the contrast of the display screen to see it better in different lighting conditions.

To adjust the display contrast:

1. Select either **Main LCD** or **Front LCD** and press the **Select** soft key.
2. Adjust the contrast by using the Left and Right keys. Each time you press the keys, you will see the status of the display.
3. When you are satisfied, press the **Select** soft key to save the selection.

Service LED (Menu 6-2-7)

The service light on the folder blinks to indicate the service status. In this menu, you can activate or deactivate the feature of the service light.

Auto retry *(Menu 6-3)*

When this menu is set to **On**, your phone automatically redials the number when a connection fails.

Depending upon your location, the number of times your phone automatically redials the number may be different.

Answer mode *(Menu 6-4)*

This menu allows you to select how to answer an incoming call.

The following options are available:

By send key: The phone answers only when you press the  key.

By folder open: The phone answers when you open the folder. If the folder is already open, press the  key.

By any key: When the folder is open, you can press any key except for the  key, the soft keys and the Volume keys. When the folder is closed, you can answer the call by opening the folder.

Roam option *(Menu 6-5)*

Roaming is a feature which is only relevant in areas where there are at least two cellular service providers having valid roaming agreements. Roaming allows you to register your phone on one of the networks, but use the facilities of the other if your own network is not available. This system priority feature allows you to programme your phone for optimum operation within or outside your home service area.

You should always check your phone's display because it will let you know when you're outside the service provider network and whether your phone is operating in another network; the Roaming icon () appears.

You have the following options which allows you to control the phone's roaming ability:

Home only: with this setting, you cannot roam. When your home system is not available, your call is not be connected and the No Service indicator () displays.

Automatic: your phone automatically searches for the first available one of all types of services, according to the Preferred Roaming List supplied by the service provider.

Security *(Menu 6-6)*

Your phone provides you with various security options, including a user-programmable lock code and special number features.

To access the **Security** menu, you must enter the 4-digit lock code. It is preset to "0000" at the factory.

Lock mode *(Menu 6-6-1)*

In Lock mode, you cannot dial numbers, except for making an emergency call, or access menu options. The phone can receive incoming calls and messages, even though the phone is in Lock mode.

The following options are available:

Never: The phone remains unlocked.

On power up: The phone is automatically locked the next time you turn the phone on.

Now: The phone is immediately locked.

To place an emergency call in Lock mode, enter a programmed number and then press the  key. The phone recognises standard emergency numbers, such as 112, 113, 118 or 199, and three numbers programmed in the **Emergency #** menu (**Menu 6-6-3**); see the next page.

To unlock the phone, press one of the soft keys and the Navigation keys and enter the 4-digit lock code. The phone is immediately unlocked.

Change lock *(Menu 6-6-2)*

This feature allows you to change your current lock code to a new one. The lock code is preset to "0000" at the factory.

Enter a new, four-digit lock code and enter the code once again at the prompt.

Note: Your phone does not allow viewing of the lock code for security reasons. Be sure to write the lock code down or memorise it if you have changed.

Emergency # *(Menu 6-6-3)*

Your phone provides the option of storing four emergency numbers. All of these numbers can be manually dialled at any time, even if your phone is locked or all of outgoing calls are restricted.

IMPORTANT NOTICE!

Emergency calling may not be available on all wireless networks at all times. A connection cannot always be guaranteed, due to the various transmission methods, network parameters and user settings used to complete a call from your wireless phone.

DO NOT depend on this phone as a primary method of dialling 112 or for any other essential or emergency communications.

Remember to always turn your phone on and check for the adequate signal strength before placing a call.

To store an emergency number:

1. Press the Up or Down key to select the number location and press the **Select** soft key.
2. Press the **C** key to clear the existing number.
3. Enter a new number and press the **Save** soft key.

Note: 112, 113, 118, and 199, remain as emergency numbers, even if you change them on the Emergency # list.

To make an emergency call in Lock mode, simply enter one of the programmed emergency numbers and press the  key.

Voice privacy (Menu 6-6-4)

Used only in digital networks, Voice Privacy encrypts the voice channel so that people cannot eavesdrop on your conversation.

The following options are available:

Standard: The phone uses a standard line for calls.

Enhanced: The phone makes and receives calls on an encrypted high security line.

Note: This feature may not be available in all areas. Contact your service provider for its availability and details.

Restriction (Menu 6-6-5)

This feature allows you to restrict the use of your phone.

The following options are available:

Outgoing: restricts all outgoing calls from your phone except emergency calls by standard emergency numbers, such as 112, 113, 118, or 199, and the four programmed numbers on the Emergency # list (**Menu 6-6-3**).

Incoming: restricts all incoming calls.

Phonebook: restricts the access to your Phonebook. You cannot add a new entry.

When a confirming message displays, select **Yes** to restrict the calls or **No** to deactivate the restriction.

Clear memory (Menu 6-6-6)

This menu allows you to erase your Phonebook entries in the UIM card or phone's memory. You can also erase all of the entries at one time.

The following options are available:

Card: clears all of the entries stored in the card.

Phone: clears all of the entries stored in the phone's memory.

All: clears all of the Phonebook entries.

When a confirming message displays, select **Yes** to clear the memory or **No** to cancel your selection.

Reset phone *(Menu 6-6-7)*

Resetting the phone restores the default settings of all the user-selectable options.

When a confirming message displays, select **Yes** and press the **Select** soft key to confirm. The phone reboots, turning itself off and then back on, and returns to Standby mode.

Note: The UIM card and phone's memory cannot be reset.

Select **No** or press the **C** key to cancel your selection.

Card setup *(Menu 6-6-8)*

In this menu, you can use the options for the UIM card.

PIN check

When this feature is enabled, you must enter the PIN assigned to your UIM card each time you switch the phone on. Consequently, any person who does not have your PIN cannot use your phone without your approval.

Note: Before disabling the PIN Check feature, you must enter your PIN.

Change PIN

This feature allows you to change the PIN of the UIM card to a new one, provided that the PIN Check feature (**Menu 6-6-8-1**) is enabled. You must enter the current PIN before you can specify a new one.

UIM lock

When this feature is enabled, your phone only works with the current UIM card. To use a different card, you need to enter the UIM lock code.

Once you have entered the lock code, you are asked to confirm it by entering it again.

To unlock the UIM card, you must enter the UIM lock code.

Network select *(Menu 6-6-9)*

This menu allows you to select your phone's WAP browser.

Insert a card and select a suitable mode that you want to use; **Mobile-8** and **TELKOMFlexi** by using navigation keys and then press the **Save** soft key.

Note: The mode's service provider should be corresponding to the card's. Unless you select correct mode, browser and call function cannot be operated properly.

Entry method *(Menu 6-7)*

This menu allows you to select the default text input mode.

Select either **T9 word** or **ABC**.

Camera

Using the camera module built into your phone, you can take photos of people or events while on the move. You can send photos to other people using a message or set a photo as a wallpaper image or an opening or closing image.

You can also record a video using the camera.

Note: You can quickly enter this menu by pressing the Camera key () on the right side of the phone in Standby mode.

CAUTION:

- Do not take photos of people without their permission.
- Do not take photos in a place where cameras are not allowed.
- Do not take photos in a place where you may interfere with another person's privacy.

Taking a photo

The camera produces JPEG photos. You can take photos with the folder open or closed. When the folder is closed, you can use the external display.

Note: When you take a photo in direct sunlight or in bright conditions, shadows may appear on the photo.

Taking a photo with the folder open

1. In Standby mode, press and hold the  key on the right side of the phone.

The image to be captured appears on the display.

2. Adjust the image by aiming the camera module at the subject.

| 3. To | Press the |
|-----------------------------|---|
| flip the image vertically | ▲ key. |
| flip the image horizontally | ▼ key. |
| zoom in or out | Left or Right key. |
| change the image brightness | Up or Down key. |
| use the options | Option soft key. See the next page. |

Notes:

- When the resolution is set to **High**, changing the image size is not available.
- The image size of your photo can be different when you open it to on your PC using the PC link programme. To view the real image size, press the **0** key in Capture mode.

4. Press the **Capture** soft key or the  key to take the photo.

5. Press the **Save** soft key.

To discard the photo and go back to Capture mode, press the **Cancel** soft key.

6. Clear the default name using the **C** key, if necessary, and enter a photo name.

For further details about entering characters, see page 45.

7. Press the **OK** soft key.

The phone saves the photo in the **Photo album** menu (**Menu 7-3**) and returns to Capture mode.

8. When you are finished, press the  key to return to Standby mode.

Using the camera options in capture mode

When you press the **Option** soft key in Capture mode, the following options are available for the current shot:

Record video

Selecting this option switches the phone to Record mode. See page 125.

Self timer

You can set the phone to take a picture at a predefined time. When you press the **Capture** soft key or the  key, the timer appears on the bottom line of the display and starts counting down.

Multi shot

This option allows you to take successive action stills up to seven shots. Select the interval between shots, **Off**, **Short**, **Normal**, or **Long**.

Brightness

You can adjust the brightness of the image. When **auto** is selected, the phone automatically determines the setting.

Fun frame

This option allows you to use a frame with the photo. Press the Navigation keys to find the frame format you want to use.

Resolution



You can change the image resolution, **High**, **Medium**, **Full**, or **Low**.

Taking a photo with the folder closed

1. When the folder is closed, press and hold the  key on the right side of the phone.

The image to be captured displays on the external display.

2. Adjust the image by aiming the camera module.

To use the options, press the  key until the option icon is selected. You can change the settings by pressing the  key. The following options are available:



: allows you to flip the image vertically.



auto: allows you to adjust the brightness of the image.



: allows you to enlarge the image.

3. Press the  key to take the photo.

The phone saves the photo in the **Photo album** menu (**Menu 7-3**) and returns to Capture mode.

Take photo *(Menu 7-1)*

This menu allows you to take a photo.

Accessing this menu turns the camera on and the display switches to Capture mode. For further details about taking a photo, see page 121.

Record video *(Menu 7-2)*

In this menu, you can record a video that is currently displayed on the camera screen and save it as a JPEG file.



To record a video:

1. Accessing the **Record video (Menu 7-2)** menu turns on the camera at the top of the phone.

The image to be recorded appears on the display.

2. Adjust the image by aiming the camera at the subject.

| To | Press the |
|-----------------------------|---|
| flip the image vertically | ▲ key. |
| flip the image horizontally | ▼ key. |
| change the image brightness | Up or Down key. |
| use the options | Option soft key. See the next page. |

4. Press the **Record** soft key or the  key to start recording.
5. When you are finished, press the **Stop** soft key.
Or, the phone automatically stops when you have reached the limit of available memory for a video.
6. Press the **Save** soft key.
To discard the video and go back to Record mode, press the **Cancel** soft key.
7. Clear the default name using the **C** key, if necessary, and enter a video name.
For further details about entering characters, see page 45.
8. Press the **OK** soft key.
The phone saves the video in the **Video album** menu (**Menu 7-4**) and returns to Record mode.
9. When you are finished, press the  key to return to Standby mode.

Using the camera options in record mode

When you press the **Option** soft key in Record mode, the following options are available:

Take picture

Selecting this option switches the phone to Capture mode. See page 121.

Voice REC.

You can set the phone to record the audio with the video.

Self timer

You can set the phone to start recording at a predefined time. The timer appears on the bottom line of the display and starts counting down.

Brightness

You can adjust the brightness of the image. When the brightness is selected to **auto**, the phone automatically determines the setting.

Photo album *(Menu 7-3)*

In this menu, you can review the photos you have taken. By default, your phone displays the first photo you took on the full screen, Expand mode. Use the Left and Right keys to scroll through the photos.

To view the photos as a small images, press the **Thumbnail** soft key. In this mode, you can scroll through the photos by using the Navigation keys. To go back to Expand mode, press **Expand** soft key.

Using the photo options

Press the **Option** soft key to use the following options:

Note: The available options are different depending on the current view mode, Thumbnail or Expand mode.

Assign

This option allows you to set the photo as your wallpaper for the idle screen or an image to be displayed when you turn the phone on or off.

Rename

This option allows you to change the name of the photo.

Lock

This option allows you to lock the photo so that other people cannot access the photo without your lock code.

Erase

This option allows you to erase the photo.

Erase all

This option allows you to erase all of the photos.

Photo info

This option shows you information about the current photo, such as the name, time and date when it was taken, image size and file format.

Slide show

This option shows you the photos as a slide show.

Video album *(Menu 7-4)*

In this menu, you can play the video files you recorded. When you access this menu, the still image of the first video displays.

To play a video:

1. Press the Left or Right key to scroll to the video you want to view.

You can use the Video options by pressing the **Option** soft key. See page 130.
2. Press the **Play** soft key to start playing the video.
3. To stop, press the **Stop** soft key or **C** key.
4. To return to Standby mode, press the  key.

Using the video options

Press the **Option** soft key on the Video Album screen to use the following options:

Rename

This option allows you to change the name of the video.

Lock

This option allows you to lock the video so that other people cannot access the video without your lock code.

Erase

This option allows you to erase the video.

Erase all

This option allows you to erase all of the videos.

Video info

This option shows you information about the current video, such as the name, time and date when it was recorded, video size and file format.

Settings *(Menu 7-5)*

This menu allows you to change the default settings of the options for using the camera.

The following options are available:

Resolution: allows you to adjust the resolution of the image. You can select either **High:640X480**, **Medium:320X240**, **Full:128X160**, or **Low:128X96**.

Fun frames: allows you to use a frame with the photo. Press the Navigation keys to find the frame format you want to use.

Shutter sound: allows you select the tone that sounds when you press the **Capture** soft key or the  key.

Quality: allows you to change the image quality. You can select either **Fine**, **Normal**, or **Economy**.

Memory status *(Menu 7-6)*

You can check the amount of the memory being used and the memory remaining for the Camera feature.

The display shows the total, free and used space.

Wireless web

About the Web browser

Your phone comes equipped with a web browser which makes it possible for you to access the wireless web.

The web browser allows you to access up-to-the minute information through your phone. Browsing the wireless web through your phone is unlike using your computer; site providers have selected only critical aspects of their sites to present to wireless phone users and they have removed most of the graphics.

Each time you start the web browser, the phone will connect to the wireless web and the Service icon () will appear on the display. Any time this icon is visible on the display, you are connected to the wireless web and will be billed accordingly. Rates vary according to your service option.

The web browser will end the connection after a certain period of network inactivity and will automatically reconnect as necessary. For this reason, you may find that you are billed for several network connections within a single session. This is normal and is designed to minimize your bill.

Press the **i** key in Standby mode.

Exiting the Web browser

To exit the web browser, simply press the  key at any time.

Navigating the Web browser

When you use the web browser, some keys on your phone operate differently from that of a normal phone call. These keys are explained below. The web browser presents on-screen items in one of the following ways:

- text or numeric input
- links (embedded in content)
- numbered options (some options may not be numbered)
- simple text

Here's how the keys work in the Web Browser:



Navigation keys: Use these keys to scroll to and select browser options. You can also use them to move the cursor when editing text.



Left soft key: This is the left soft key used to execute the commands at the bottom left of the browser display.



Right soft key: This is the right soft key used to execute the commands at the bottom right of the browser display.



Cursor keys: Use these keys to move the cursor when entering text.



END key: This key ends the web browser connection and returns the phone to Standby mode.



Clear key: This key performs two important functions:

- Sends you back in the browser. Pressing it once sends you back one page. Pressing and holding this key sends you back to the homepage.
- Clears out entered text or numbers. When entering characters, press this key to clear the last number, letter or symbol. Press and hold this key to completely clear the input field.



Numbered keys 0 - 9: If the items on a page are numbered, you can use these keys to select them.



Volume keys: These keys allow you to scroll up or down by page or change the volume setting.

Using the Web browser menu

On the web browser, you can access the following options by pressing the **i** key.

Home: takes you back at any time to the homepage of the wireless web service provider.

Forward: takes you one page forward in the sequence of pages or sites you've already visited.

Bookmarks: allows you to load a bookmarked web page directly.

Go To URL: allows you to manually enter a URL address to access a site.

History: shows you the list of the web pages you have visited.

Snapshots: allows you to take a "snap shot" of the current screen.

Reload: reloads the current web page with updated information.

Advanced...: gives you access to the following advanced features:

- Restart Browser: restarts the browser without exiting it.
- Delete Cookies: deletes the cookies containing user information in your phone.
- Homepage: allows you to change the startup homepage URL address.
- Multimedia: allows you to change the options related to multimedia contents on the page.
- View Title Region: allows you to view or hide the title bar.
- Scroll Mode: allows you to select the display's scroll mode and speed for long text.
- Connection Timeout: allows you to set the duration the browser will wait for acknowledgement after a request is sent. If there is no response within the specified time, the browser connection ends.

- **Key Press Timeout:** allows you to change the latency between key presses of a single key.

- **Security:** gives you access to the following security options:

Secure Prompt: displays when you are about to leave a secure site and enter a non-secure site.

Authentication: allows you to turn authentication caching on or off.

Current Certificate: displays the current certificate, if one is used.

About...: displays information about the browser and the browser version.

Entering text in the Web browser

When prompted, you can enter letters, numbers or symbols. To change the input mode, press the right soft key. The following modes are available:

abc: allows you to enter alphabet letters by pressing the corresponding keys until the letter you want display.

Sym: allows you to enter symbols.

123: allows you to enter numbers.

word: allows you to enter English letters using T9 mode.

For further details about each mode, see page 45.

Health and safety information

SAR certification information

This phone meets European Union (EU) requirements concerning exposure to radio waves. Your mobile phone is a radio transmitter and receiver. It is designed and manufactured so as not to exceed the limits for exposure to radio-frequency (RF) energy, as recommended by the EU Council. These limits are part of comprehensive guidelines and establish permitted levels of RF energy for the general population. The guidelines were developed by independent scientific organisations through the periodic and thorough evaluation of scientific studies. The limits include a substantial safety margin designed to ensure the safety of all persons, regardless of age and health.

The exposure standard for mobile phones employs a unit of measurement known as SAR (Specific Absorption Rate). The SAR limit recommended by the EU Council is 2.0W/kg.

The highest SAR value for this model phone was 0.789 W/kg.

* The SAR limit for mobile phones used by the public is 2.0 watts/kilogram (W/kg) averaged over ten grams of body tissue. The limit incorporates a substantial margin of safety to give additional protection for the public and to account for any variations in measurements. The SAR values may vary, depending on national reporting requirements and the network band.

SAR tests are conducted using standard operating positions with the phone transmitting at its highest certified power level in all tested frequency bands. Although the SAR is determined at the highest certified power level, the actual SAR level of the phone while operating can be well below the maximum value. This is because the phone is designed to operate at multiple power levels so as to use only the power required to reach the network. In general, the closer you are to a base station, the lower the power output of the phone.

Precautions when using batteries

- Never use any charger or battery that is damaged in any way.
- Use the battery only for its intended purpose.
- If you use the phone near the network's base station, it uses less power; talk and standby time are greatly affected by the signal strength on the cellular network and the parameters set by the network operator.
- Battery charging time depends on the remaining battery charge, the type of battery and the charger used. The battery can be charged and discharged hundreds of times, but it will gradually wear out. When the operation time (talk time and standby time) is noticeably shorter than normal, it is time to buy a new battery.

- If left unused, a fully charged battery will discharge itself over time.
- Use only Samsung-approved batteries and recharge your battery only with Samsung-approved chargers. When a charger is not in use, disconnect it from the power source. Do not leave the battery connected to a charger for more than a week, since overcharging may shorten its life.
- Extreme temperatures will affect the charging capacity of your battery: it may require cooling or warming first.
- Do not leave the battery in hot or cold places, such as in a car in summer or winter conditions, as you will reduce the capacity and lifetime of the battery. Always try to keep the battery at room temperature. A phone with a hot or cold battery may temporarily not work, even when the battery is fully charged. Li-ion batteries are particularly affected by temperatures below 0 °C (32 °F).
- Do not short-circuit the battery. Accidental short-circuiting can occur when a metallic object (coin, clip or pen) causes a direct connection between the + and – terminals of the battery (metal strips on the battery), for example when you carry a spare battery in a pocket or bag. Short-circuiting the terminals may damage the battery or the object causing the short-circuiting.
- Dispose of used batteries in accordance with local regulations. Always recycle. Do not dispose of batteries in a fire.

Road safety

Your wireless phone gives you the powerful ability to communicate by voice, almost anywhere, anytime. But an important responsibility accompanies the benefits of wireless phones, one that every user must uphold.

When driving a car, driving is your first responsibility. When using your wireless phone behind the wheel of a car, make sure that you are following the special regulations in a given area or country.

Operating environment

Remember to follow any special regulations in force in any area and always switch your phone off whenever it is forbidden to use it, or when it may cause interference or danger.

When connecting the phone or any accessory to another device, read its user's guide for detailed safety instructions. Do not connect incompatible products.

As with other mobile radio transmitting equipment, users are advised that for the satisfactory operation of the equipment and for the safety of personnel, it is recommended that the equipment should only be used in the normal operating position (held to your ear with the antenna pointing over your shoulder).

Electronic devices

Most modern electronic equipment is shielded from radio frequency (RF) signals. However, certain electronic equipment may not be shielded against the RF signals from your wireless phone. Consult the manufacturer to discuss alternatives.

Pacemakers

Pacemaker manufacturers recommend that a minimum distance of 15 cm (6 inches) be maintained between a wireless phone and a pacemaker to avoid potential interference with the pacemaker. These recommendations are consistent with the independent research and recommendations of Wireless Technology Research.

Persons with pacemakers:

- Should always keep the phone more than 15 cm (6 inches) from their pacemaker when the phone is switched on
- Should not carry the phone in a breast pocket
- Should use the ear opposite the pacemaker to minimise potential interference

If you have any reason to suspect that interference is taking place, switch your phone off immediately.

Hearing aids

Some digital wireless phones may interfere with some hearing aids. In the event of such interference, you may wish to consult your hearing aid manufacturer to discuss alternatives.

Other medical devices

If you use any other personal medical devices, consult the manufacturer of your device to determine if it is adequately shielded from external RF energy. Your physician may be able to assist you in obtaining this information. Switch your phone off in health care facilities when any regulations posted in these areas instruct you to do so. Hospitals or health care facilities may be using equipment that could be sensitive to external RF energy.

Vehicles

RF signals may affect improperly installed or inadequately shielded electronic systems in motor vehicles. Check with the manufacturer or its representative regarding your vehicle. You should also consult the manufacturer of any equipment that has been added to your vehicle.

Posted facilities

Switch your phone off in any facility where posted notices require you to do so.

Potentially explosive environments

Switch your phone off when in any area with a potentially explosive atmosphere and obey all signs and instructions. Sparks in such areas could cause an explosion or fire resulting in bodily injury or even death.

Users are advised to switch the phone off while at a refuelling point (service station). Users are reminded of the need to observe restrictions on the use of radio equipment in fuel depots (fuel storage and distribution areas), chemical plants or where blasting operations are in progress.

Areas with a potentially explosive atmosphere are often but not always clearly marked. They include the areas below decks on boats, chemical transfer or storage facilities, vehicles using liquefied petroleum gas, such as propane or butane, areas where the air contains chemicals or particles, such as grain, dust or metal powders, and any other area where you would normally be advised to turn off your vehicle engine.

Emergency calls

This phone, like any wireless phone, operates using radio signals, wireless and landline networks as well as user-programmed functions, which cannot guarantee connection in all conditions. Therefore, you should never rely solely on any wireless phone for essential communications (medical emergencies, for example).

Remember, to make or receive any calls the phone must be switched on and in a service area with adequate signal strength. Emergency calls may not be possible on all wireless phone networks or when certain network services and/or phone features are in use. Check with local service providers.

To make an emergency call, proceed as follows:

1. If the phone is not on, switch it on.
2. Key in the emergency number for your present location (for example, 112, 113, 118, 199, or any other official emergency number). Emergency numbers vary by location.
3. Press the  key.

If certain features are in use (call barring, for example), you may first need to deactivate those features before you can make an emergency call. Consult this document and your local cellular service provider.

When making an emergency call, remember to give all the necessary information as accurately as possible. Remember that your phone may be the only means of communication at the scene of an accident; do not cut off the call until given permission to do so.

Other important safety information

- Only qualified personnel should service the phone or install the phone in a vehicle. Faulty installation or service may be dangerous and may invalidate any warranty applicable to the device.
- Check regularly that all wireless phone equipment in your vehicle is mounted and operating properly.
- Do not store or carry flammable liquids, gases or explosive materials in the same compartment as the phone, its parts or accessories.
- For vehicles equipped with an air bag, remember that an air bag inflates with great force. Do not place objects, including both installed or portable wireless equipment in the area over the air bag or in the air bag deployment area. If wireless equipment is improperly installed and the air bag inflates, serious injury could result.
- Switch your phone off before boarding an aircraft. The use of wireless phones in aircraft may be dangerous to the operation of the aircraft, and is illegal.

- Failure to observe these instructions may lead to the suspension or denial of telephone services to the offender, or legal action, or both.

Care and maintenance

Your phone is a product of superior design and craftsmanship and should be treated with care. The suggestions below will help you fulfill any warranty obligations and allow you to enjoy this product for many years.

- Keep the phone and all its parts and accessories out of the reach of small children's.
- Keep the phone dry. Precipitation, humidity and liquids contain minerals that will corrode electronic circuits.
- Do not use the phone with a wet hand. Doing so may cause an electric shock to you or damage to the phone.
- Do not use or store the phone in dusty, dirty areas, as its moving parts may be damaged.
- Do not store the phone in hot areas. High temperatures can shorten the life of electronic devices, damage batteries, and warp or melt certain plastics.

- Do not store the phone in cold areas. When the phone warms up to its normal operating temperature, moisture can form inside the phone, which may damage the phone's electronic circuit boards.
- Do not drop, knock or shake the phone. Rough handling can break internal circuit boards.
- Do not use harsh chemicals, cleaning solvents or strong detergents to clean the phone. Wipe it with a soft cloth slightly dampened in a mild soap-and-water solution.
- Do not paint the phone. Paint can clog the device's moving parts and prevent proper operation.
- Do not put the phone in or on heating devices, such as a microwave oven, a stove or a radiator. The phone may explode when overheated.
- Use only the supplied or an approved replacement antenna. Unauthorised antennas or modified accessories may damage the phone and violate regulations governing radio devices.
- If the phone, battery, charger or any accessory is not working properly, take it to your nearest qualified service facility. The personnel there will assist you, and if necessary, arrange for service.

Glossary

Air time - Actual time spent talking on the wireless phone. Most carriers bill customers based on how many minutes of airtime they use each month.

Antenna - A device for transmitting or receiving signals. The size and shape of antennas is determined, in part, by the frequency of the signal they receive. Wireless phones and the base station must have antennas.

Base station - The fixed radio transmitter/receiver that maintains communications with mobile radio telephones within a given area. (Typically called a cell or cell site)

CDMA - (Code Division Multiple Access) A spread-spectrum approach to digital transmission. With CDMA, each conversation is digitized and then tagged with a code. The mobile phone deciphers only a particular code to pick the right conversation off the air. The transmitted signal is just above noise level across the available bandwidth.

Channel - Communications signals transmit along paths called channels.

Codec coder/Decoder - Compression & decompression.

Deactivation - The process of rendering a wireless phone inactive.

DTMF - (Dual-Tone Multi-Frequency) You send DTMF signals when you enter numbers by pressing the digit keys.

EVRC - (Enhanced Variable Rate Codec) EVRC is a new global standard for compressing and decompressing voice signals. EVRC uses a lower bit rate (the number of bits sent per second) than existing CDMA vocoders, while providing significant improvements in voice quality. This technology enables your phone to provide superb voice quality while benefiting from the ability to process more cellular voice calls using less bandwidth than the voice codecs in CDMA networks today.

Frequency - A measure based on time, as one or more waves per second, in an electrical or light wave information signal. A signal's frequency is stated in cycles-per-second or Hertz (Hz).

LCD - (Liquid Crystal Display) Commonly used to refer to the screen display on the wireless phone.

Prepend - The addition of a prefix, such as an area code, to a phone number.

RF - Radio Frequency

Roaming - The ability to use a wireless phone to make and receive calls in places outside of the home service area.

Service charge - The amount paid each month to receive wireless service.

Standby time - The amount of time a fully charged wireless portable or transportable phone can be on and idle without being in use. (See Talk Time)

Talk time - The length of time a person can talk on a portable or transportable wireless phone without recharging the battery.

Vocoder - Voice Coder. A device used to convert speech into digital signals.

Wireless - Radio-based Systems that allow transmission of telephone or data signals through the air without a physical connection, such as a metal wire (copper) or fiber optic cable.



SCH-X619 Quick reference card

BASIC OPERATION

| | | | |
|-------------------------------------|---|----------------------------------|--|
| Make a call | Phone number + | Record a video | + 2 + Record / + Stop + Save + OK |
| End a call | /Close the folder | Store a new number in the memory | <ul style="list-style-type: none"> • In the UIM card Phone number - Save + Name + OK + Save • In the phone's memory Phone number + Save + Name + OK + Down(Storage) + Phone + Up/Down/Left/Right (Type) + Select + Up/Down(Name/Storage/Location/Home/Office/Mobile/Pager/Fax/E-Mail/E-Mail2/ETC/Load Image/Speedial/Group/Finger) + Edit and enter information or Left/Right + Save |
| Receive a call | /Open the folder | | |
| Adjust the key tone volume | (in Standby mode) / on the left side | | |
| Adjust the voice volume | (during a conversation) / on the left side | | |
| Redial the last call | twice/Hold | | |
| Switch to Silent mode | (in Standby mode) Hold # | | |
| Quickly change the call finger type | Hold * + Navigation + Select | Speed dial - Card | |
| Take a photo with the folder open | + 1 + Capture / + Save + OK | - Phone | Location number + Hold the last digit Location number + Hold # |
| Take a photo with the folder closed | Hold + | Scan memories | Find + Up/Down+ OK |



MENU TREE

Main Menu (To access, press the **Menu** soft key)

| | | | |
|--------------|---|------------------|--|
| 1: Calls | 1: Missed 2: Incoming 3: Outgoing 4: Erase logs 5: Air time 6: Call forward 7: Call waiting | 4: Scheduler | 7: Memo pad 8: Countdown 9: World time |
| 2: Phonebook | 1: Find 2: Add 3: Group set 4: My phone # | 5: Entertainment | 1: Music box 2: Image box 3: Games 4: MP3 player 5: Memory status |
| 3: Messages | 1: New message 2: Inbox 3: Outbox 4: Erase msgs 5: Msg setup | 6: Settings | 1: Sound 2: Display 3: Auto rery 4: Answer mode 5: Roam option 6: Security 7: Entry method |
| 4: Scheduler | 1: View month 2: Jump to date 3: Alarm set 4: Calculator 5: Today 6: To do list | 7: Camera | 1: Take photo 2: Record video 3: Photo album 4: Video album 5: Settings 6: Memory status |

* Available depending on your UIM card

Licensed by QUALCOMM Incorporated under one or more of the following Patents.

U.S Patent No. 4,901,307 5,056,109 5,099,204
 5,101,501 5,103,459 5,107,225
 5,109,390