

SCH-B279 User Manual

- Some of the contents in this manual may differ from your phone depending on the software of the phone or your service provider.



World Wide Web
<http://www.samsungmobile.com>

Printed in China
Code No. | GH68-20993A
English. 10/2008. Rev.1.0

safety and usage information

Comply with the following precautions to avoid dangerous or illegal situations and ensure peak performance of your mobile phone.



Safety warnings

Keep your phone away from small children and pets

Keep your phone and all accessories out of the reach of small children or animals. Small parts may cause choking or serious injury if swallowed.

Protect your hearing



Listening to a headset at high volumes can damage your hearing. Use only the minimum volume setting necessary to hear your conversation or music.

Install mobile phones and equipment with caution

Ensure that any mobile phones or related equipment installed in your vehicle are securely mounted. Avoid placing your phone and accessories near or in an air bag deployment area. Improperly installed wireless equipment can cause serious injury when air bags inflate rapidly.

Handle and dispose of batteries and chargers with care

- Use only Samsung-approved batteries and chargers specifically designed for your phone. Incompatible batteries and chargers can cause serious injuries or damage to your phone.
- Never dispose of batteries in a fire. Follow all local regulations when disposing used batteries.
- Never place batteries or phones on or in heating devices, such as microwave ovens, stoves, or radiators. Batteries may explode when overheated.
- Never crush or puncture the battery. Avoid exposing the battery to high external pressure, which can lead to an internal short circuit and overheating.

Avoid interference with pacemakers

Maintain a minimum of 15 cm (6 inches) between mobile phones and pacemakers to avoid potential interference, as recommended by manufacturers and the independent research group, Wireless Technology Research. If you have any reason to suspect that your phone is interfering with a pacemaker or other medical device, turn off the phone immediately and contact the manufacturer of the pacemaker or medical device for guidance.

Turn off the phone in potentially explosive environments

Do not use your phone at refuelling points (service stations) or near fuels or chemicals. Turn off your phone whenever directed by warning signs or instructions. Your phone could cause explosions or fire in and around fuel or chemical storage and transfer areas or blasting areas. Do not store or carry flammable liquids, gases, or explosive materials in the same compartment as the phone, its parts, or accessories.

Reduce the risk of repetitive motion injuries

When sending text messages or playing games on your phone, hold the phone with a relaxed grip, press the buttons lightly, use special features that reduce the number of buttons you have to press (such as templates and predictive text), and take frequent breaks.

WARNING

WARNING

WARNING



Safety precautions

Drive safely at all times

Avoid using your phone while driving and obey all regulations that restrict the use of mobile phones while driving. Use hands-free accessories to increase your safety when possible.

Follow all safety warnings and regulations

Comply with any regulations that restrict the use of a mobile phone in a certain area.

Use only Samsung-approved accessories

Using incompatible accessories may damage your phone or cause injury.

Turn off the phone near medical equipment

Your phone can interfere with medical equipment in hospitals or health care facilities. Follow all regulations, posted warnings, and directions from medical personnel.

Turn off the phone or disable the wireless functions when in an aircraft

Your phone can cause interference with aircraft equipment. Follow all airline regulations and turn off your phone or switch to a mode that disables the wireless functions when directed by airline personnel.

Protect batteries and chargers from damage

- Avoid exposing batteries to very cold or very hot temperatures (below 0° C/32° F or above 45° C/113° F). Extreme temperatures can reduce the charging capacity and life of your batteries.
- Prevent batteries from contacting metal objects, as this can create a connection between the + and - terminals of your batteries and lead to temporary or permanent battery damage.
- Never use a damaged charger or battery.

Handle your phone carefully and sensibly

- Do not allow your phone to get wet—liquids can cause serious damage. Do not handle your phone with wet hands. Water damage to your phone can void your manufacturer's warranty.
- Avoid using or storing your phone in dusty, dirty areas to prevent damage to moving parts.
- Your phone is a complex electronic device—protect it from impacts and rough handling to avoid serious damage.
- Do not paint your phone, as paint can clog moving parts and prevent proper operation.
- Avoid using the phone's camera flash or light close to the eyes of children or animals.
- Your phone and memory cards may be damaged by exposure to magnetic fields. Do not use carrying cases or accessories with magnetic closures or allow your phone to come in contact with magnetic fields for extended periods of time.

Avoid interference with other electronic devices

Your phone emits radio frequency (RF) signals that may interfere with unshielded or improperly shielded electronic equipment, such as pacemakers, hearing aids, medical devices, and other electronic devices in homes or vehicles. Consult the manufacturers of your electronic devices to solve any interference problems you experience.



Important usage information

Use your phone in the normal position

Avoid contact with your phone's internal antenna.

Allow only qualified personnel to service your phone

Allowing unqualified personnel to service your phone may result in damage to your phone and will void your warranty.

Ensure maximum battery and charger life

- Avoid charging batteries for more than a week, as overcharging may shorten battery life.
- Over time, unused batteries will discharge and must be recharged before use.
- Disconnect chargers from power sources when not in use.
- Use batteries only for their intended purpose.

Handle UIM cards and memory cards with care

- Do not remove a card while the phone is transferring or accessing information, as this could result in loss of data and/or damage to the card or phone.
- Protect cards from strong shocks, static electricity, and electrical noise from other devices.
- Frequent writing and erasing will shorten the life span of memory cards.
- Do not touch gold-coloured contacts or terminals with your fingers or metal objects. If dirty, wipe the card with a soft cloth.

Ensure access to emergency services

Emergency calls from your phone may not be possible in some areas or circumstances. Before travelling in remote or undeveloped areas, plan an alternate method of contacting emergency services personnel.

SAR information

Your wireless phone is a radio transmitter and receiver. It is designed and manufactured not to exceed the emission limits for exposure to radio frequency (RF) energy set by the European Union (EU) Council. These limits are part of comprehensive guidelines and establish permitted levels of RF energy for the general population. The guidelines are based on the safety standards that were developed by independent scientific organisations through periodic and thorough evaluation of scientific studies. The standards include a substantial safety margin designed to assure the safety of all persons, regardless of age and health. The exposure standard for wireless phones employs a unit of measurement known as Specific Absorption Rate (SAR). The SAR limit set by the EU Council is 2.0W/kg.

Installing the UIM card and battery

1. Remove the battery cover and insert the UIM card.
2. Insert the battery and replace the battery cover.

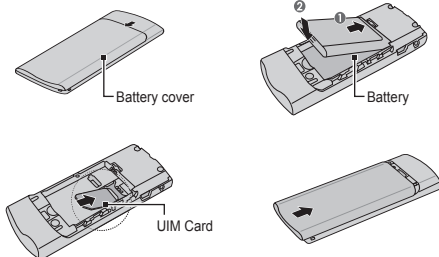

Charging the battery

1. Plug the supplied travel adapter.

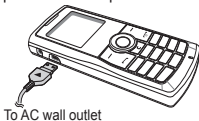

2. When charging is finished, unplug the adapter.

Note Do not remove the battery from the phone without unplugging the adapter first. Otherwise, the phone may be damaged.

Entering text

To change the text input mode

In a text input field, press < **Mode** > and select the input mode you want.

T9 Word mode or T9 Hindi mode

1. Press keys [2] to [9] to start entering a word. Press each key only once for one letter.
The word you are entering appears on the display. It may change with each keypress. Finish entering the word before editing or deleting any keystrokes.
2. Press [#] to insert a space and enter the next word.

ABC mode or Hindi mode

Press the keys labelled with the letter you want once for the first letter, twice for the second letter, and so on.

Number mode

Press the number keys corresponding to the digits you want.

Hinglish mode

Press the appropriate alphanumeric key to enter a Hinglish word, which is made by combining of Hindi and English according to Hindi grammar.

Symbol mode

Press the number keys corresponding to the symbols you want. You can press left or right to display more symbols.



- To move the cursor, press the Navigation keys.
- To delete characters one by one, press [C]. To delete characters on the left side of the cursor, press and hold [C].
- To insert a space between characters, press [#].
- To change case in T9 Word mode or ABC mode, press [*].
- To enter punctuation marks in ABC mode, press [1].

Phone layout and keys

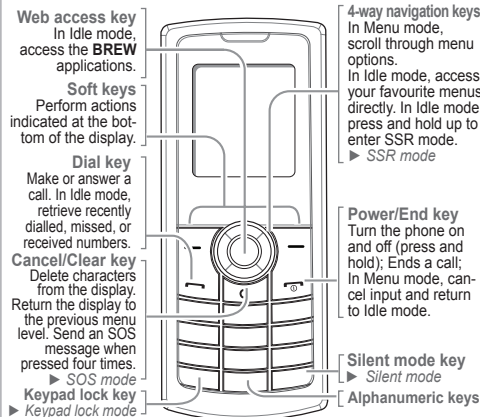

- SSR mode** Press and hold **up** in Idle mode to activate or deactivate the SSR (Simple Smart Ringtone) mode. The SSR mode is for alerting you to incoming calls in noisy places, by simultaneously vibrating and ringing at its highest volume.
- Silent mode** Press and hold [#] in Idle mode to disable all sounds on the phone. To exit, press and hold this key again.
- Keypad lock mode** Press and hold [*] in Idle mode to lock the keypad to ignore accidental key pressing. To unlock, press the left soft key and then [*].
- SOS mode** Press [C] four times in Idle mode, with the keypad locked to send an SOS message to preset numbers. Once the SOS message is sent, the phone will change to SOS mode and will receive calls only from the registered recipients. Upon receiving a call from the SOS message recipients, the phone will automatically answer the call. Press [*] to exit SOS mode.

Sending and viewing messages

To send a text message

1. In Idle mode, press < **Menu** > → **Messages** → **Write**.
2. Enter the text message and press < **OK** > .
3. Scroll left or right to select **Save & send** or **Send only**.
4. Press < **OK** > .
5. Enter a destination number.
6. Press < **OK** > to send the message.

To view text messages

1. In Idle mode, press < **Menu** > → **Messages** → **Inbox** → **Phone** or **Card**.
2. Select a text message.

Listening to the FM radio

To listen to the radio

1. Connect the supplied headset to the phone.
2. In Idle mode, press < **Menu** > → **Tools** → **FM Radio**.
3. Press left or right to find available radio stations. You can also press and hold left or right.
4. Press < **Back** > or [C] to turn off the radio.

To store radio stations

By automatic tuning:

1. From the radio screen, press < **Options** > → **Automatic tuning**.
2. Available radio stations will be listed in the preset channels list.
3. Scroll to a station and press < **Select** > .

By manual setup:

1. Press left or right to select the station you want.
2. Press < **Options** > → **Save as a station**.
3. Insert the channel details and press < **Save** > .

Your phone displays the following status indicators on the top of the screen:

Icon	Description
	Received signal strength
	Call in progress
	Out of your service area; you cannot make or receive calls except for emergency calls
	SOS message feature active
	Roaming network
	Text message
	SOS message or urgent text message
	Alarm set
	Lock mode
	Restriction on
	Ringer type setting
	SSR mode
	Silent mode
	Battery power level

Instructional symbols

	Note notes, usage tips, or additional information
	Followed by the order of options or menus you must select to perform a step; for example: Press < Menu > → Messages → Write (represents Menu , followed by Messages , followed by Write)
	Square brackets phone keys; for example: [*] (represents the Power/Menu exit key)
	Angled brackets softkeys that control different functions at each screen; for example: < OK > (represents the OK softkey)

Activating the mobile tracker

This feature helps track your phone when it is stolen or when someone tries to use your phone using other UIM card, the phone will automatically send the preset tracking message to family or friends. This feature may be unavailable due to certain features supported by your service provider.

1. In Idle mode, press < **Menu** > → **Settings** → **Security** → **Mobile tracker 2.0**.
2. Select **Settings**.
3. Enter a new 8-digit password for the mobile tracker and press < **OK** > .
4. Enter the new password again and press < **OK** > .
5. Scroll left or right to **ON**.
6. Scroll down and press < **Options** > → **Add recipient** to enter the recipient list.
7. Press < **Options** > → **OK** to save the recipients.
8. Scroll down and press < **Options** > → **Edit** to enter the sender's name.
9. Press < **Options** > → **Save**.
10. Press < **OK** > → **Yes**.



By setting the options in **Access remote phone**, you can delete data on your lost phone, or receive calls to the phone, or get the phone's contacts or the phone's location information from the specified phone.

Switching on or off the phone

1. Press and hold [*] for more than two seconds to switch on the phone.
2. To switch off the phone, press and hold [*] for more than two seconds.

Changing the display language

1. In Idle mode, press < **Menu** > → **Settings** → **Display** → **English/ [*]**.
2. Select a language.

Making a call

1. In Idle mode, enter an area code and phone number, and press [*].
2. Press [*] to end the call.
3. To dial the recent numbers you have called, press [*] and scroll to the number you want to make a call.
4. Press [*] to make a call.

Answering a call

1. When the phone rings, press [*] to answer a call.
To reject the call, press < **Reject** > or [*].
2. To end the call, press [*].

Adjusting the volume

1. In Idle mode, press < **Menu** > → **Settings** → **Sounds** → **Ringer vol./type** → **Voice calls** → **Volume**.
2. Press the Navigation keys to adjust the volume level.
Press < **Play** > to check the volume level.
3. Press < **OK** > .
While a call is in progress, press up or down to adjust the earpiece volume.

Changing a ringtone for calls

1. In Idle mode, press < **Menu** > → **Settings** → **Sounds** → **Ringer** → **Voice calls**.
2. Press down and press left or right to scroll to a ringer type.
3. Press down to scroll to a ringer melody.
Press < **Play** > to listen to a melody.
4. Press < **OK** > .

Using the SOS message

In an emergency, you can send SOS messages to your family or friends for help.

To set the SOS message

1. In Idle mode, press < **Menu** > → **Messages** → **SOS message** → **SOS on/off**.
2. Scroll down to select **On** and press < **Save** > .



The first time you activate SOS message, you will be asked to register recipients.

3. Press < **Search** > to open your contact list.
4. Scroll to a contact and press < **OK** > .
5. When you finish selecting the contacts, press < **OK** > to return to the recipient list.
6. Press < **OK** > to save the recipients.



You will be asked to notify to your SOS message recipients. Scroll left to select **Yes** and press < **Select** > . If you select **No**, the SOS message will not be activated.

To send an SOS message

1. With the keys locked, press [C] four times to send an SOS message to preset numbers.
2. The phone switches to SOS mode and sends the preset SOS message.
3. To exit SOS mode, press [*].